

SCALE

0 30 60
FEET

LEA ANN LANE

DENOTES PROPOSED DRIVE WAY
#2 STONE PRIOR TO EXCAVATION
1.10 % SLOPE

-DENOTES PROPOSED
SPOIL STOCKPILE
-LOCATION ESTABLISHED
BY EXCAVATOR

VACANT

DENOTES PROPOSED STAKED
EROSION CONTROL

STATE OF WISCONSIN
COUNTY OF RACINE

I HEREBY CERTIFY THAT I HAVE SURVEYED THE ABOVE DESCRIBED PROPERTY AND THE ABOVE
MAP IS A TRUE REPRESENTATION THEREOF AND SHOWS THE SIZE AND LOCATION OF THE
PROPERTY, ITS EXTERIOR BOUNDARIES, THE LOCATION OF ALL VISIBLE STRUCTURE AND
DIMENSIONS OF ALL PRINCIPLE BUILDINGS THEREON, BOUNDARY FENCES, APPARENT
EASEMENTS, ROADWAYS AND VISIBLE ENCROACHMENTS, IF ANY.

THIS SURVEY IS MADE FOR THE PRESENT OWNERS OF THE PROPERTY, AND ALSO THOSE WHO
PURCHASE, MORTGAGE, OR GUARANTEE THE TITLE THEREOF WITHIN ONE (1) YEAR FROM THE
DATE THEREOF.

DATED AT: NORTH CAPE, THIS 6TH DAY OF JUNE, 2001.

Pete L. Bailey
AMERICAN SURVEYING COMPANY, INC.
PETE L. BAILEY, RLS NO: 1398
RECERIFIED this _____ day of _____, 2001.

LEGAL DESCRIPTION:

LOT 38 OF "LAUDERDALE BAY ESTATES" A SUBDIVISION IN THE SOUTHWEST
1/4 OF SECTION 35, TOWN 4 NORTH, RANGE 16 EAST, IN THE TOWN OF LA
GRANGE, COUNTY OF WALWORTH, STATE OF WISCONSIN.

LOT AREA: 40007 SQ.FT.

-SITE HASE SOME MATURE TREED AREAS
-SCATTERED BRUSH AND UNDER GROWTH

-SUGGESTED YARD GRADE: 102.70
-SUGGESTED GARAGE SLAB: 103.03
-SUGGESTED TOP OF WALL: 103.36
-SUGGESTED FIRST FLOOR: 104.36
-SUGGESTED TOP OF FOOTING: 95.66
-SUGGESTED BASEMENT FLOOR: 95.91
-BASED ON 11 COURSES, STANDARD BLOCK

NOTE: SUGGESTED YARD GRADE
MUST BE APPROVED BY THE
OWNER AND MUNICIPALITY.

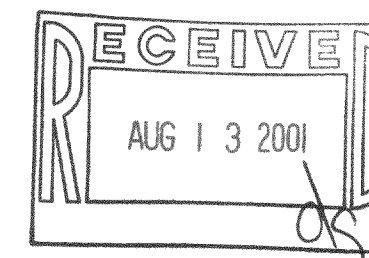
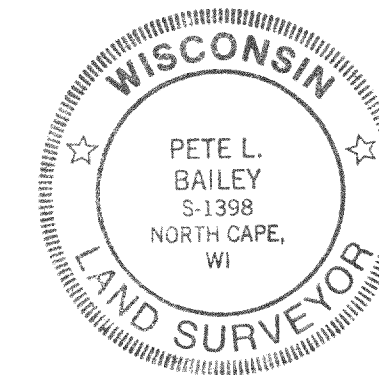

Proposed building is staked on actual corner with 6 foot offsets on the longest house line.
The contractor will be responsible to field verify all stakes for location and dimension prior
to construction. If any discrepancies should arise, notify this office at once.

Sheet
1 of 1

TOWN OF LA GRANGE

PROJECT:
PLAT OF SURVEY/ STAKE OUT SURVEY

PREPARED FOR: BADGER HOME BUILDERS, INC.
OWNERS: BERNARD & BARBARA BROSS

DRAWN BY:	PLB	REVISIONS:	DATE
CHECKED BY:	PLB		
PLOT SCALE:	1 = 30		
DATE:	06/27/2001		
JOB NO.:	01.039		
DWG. FILE:	JN201137		

A AMERICAN
SURVEYING
COMPANY, INC.

12207 C.T.H. "K" FRANKSVILLE, WISCONSIN 53126
TEL. (262) 835-4774 FAX: (262) 835-2379

HC-38

416-1706

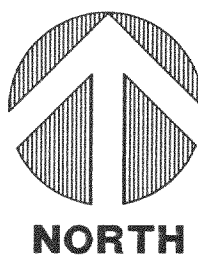

SCALE

0 30 60
FEET

NOTE: SUGGESTED YARD GRADE
MUST BE APPROVED BY THE
OWNER AND MUNICIPALITY.

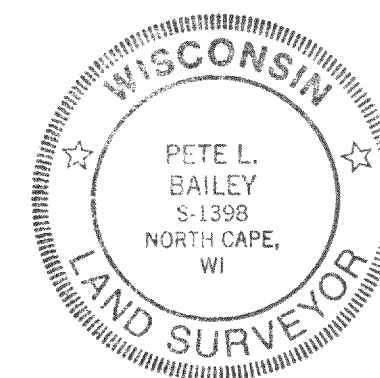

STATE OF WISCONSIN
COUNTY OF RACINE

I HEREBY CERTIFY THAT I HAVE SURVEYED THE ABOVE DESCRIBED PROPERTY AND THE ABOVE
MAP IS A TRUE REPRESENTATION THEREOF AND SHOWS THE SIZE AND LOCATION OF THE
PROPERTY, ITS EXTERIOR BOUNDARIES, THE LOCATION OF ALL VISIBLE STRUCTURE AND
DIMENSIONS OF ALL PRINCIPLE BUILDINGS THEREON, BOUNDARY FENCES, APPARENT
EASEMENTS, ROADWAYS AND VISIBLE ENCROACHMENTS, IF ANY.

THIS SURVEY IS MADE FOR THE PRESENT OWNERS OF THE PROPERTY, AND ALSO THOSE WHO
PURCHASE, MORTGAGE, OR GUARANTEE THE TITLE THEREOF WITHIN ONE (1) YEAR FROM THE
DATE THEREOF.

DATED AT: NORTH CAPE, THIS 6TH DAY OF JUNE, 2001.

AMERICAN SURVEYING COMPANY, INC.

PETE L. BAILEY, RLS NO. 1398

RECERIFIED this _____ day of _____, 2001.

LEGAL DESCRIPTION:

LOT 38 OF "LAUDERDALE BAY ESTATES" A SUBDIVISION IN THE SOUTHWEST
1/4 OF SECTION 35, TOWN 4 NORTH, RANGE 16 EAST, IN THE TOWN OF LA
GRANGE, COUNTY OF WALWORTH, STATE OF WISCONSIN.

LOT AREA: 40007 SQ.FT.

-SITE HASE SOME MATURE TREED AREAS
-SCATTERED BRUSH AND UNDER GROWTH

-SUGGESTED YARD GRADE: 102.00
-SUGGESTED GARAGE SLAB: 102.33
-SUGGESTED TOP OF WALL: 102.67
-SUGGESTED FIRST FLOOR: 103.67
-SUGGESTED TOP OF FOOTING: 94.27
-SUGGESTED BASEMENT FLOOR: 94.52
-BASED ON 12 COURSES, STANDARD BLOCK

LEA ANN LANE

DENOTES PROPOSED DRIVE WAY
#2 STONE PRIOR TO EXACAVATON
0.77 % SLOPE

-DENOTES PROPOSED
SPOIL STOCKPILE
-LOCATION ESTABLISHED
BY EXCAVATOR

DENOTES PROPOSED STAKED
EROSION CONTROL

VACANT

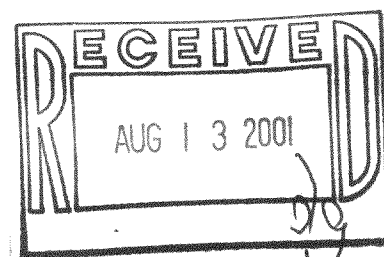

Proposed building is staked on actual corner with 6 foot offsets on the longest house line.
The contractor wil be responsible to field verify all stakes for location and dimension prior
to construction. If any discrepancies should arise, notify this office at once.

TOWN OF LA GRANGE

PROJECT:
PLAT OF SURVEY/ STAKE OUT SURVEY

PREPARED FOR: BADGER HOME BUILDERS, INC.
OWNERS: BERNARD & BARBARA BROSS

DRAWN BY: PLB

CHECKED BY: PLB

PLOT SCALE: 1 = 30

DATE: 06/27/2001

JOB NO.: 01.039

DWG. FILE: JN201137

REVISIONS: DATE

07/23/01: HOUSE MOVED FORWARD 20'
YARD GRADE REVISED, PER CINDY

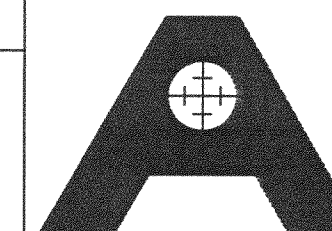

AMERICAN
SURVEYING
COMPANY, INC.

12207 C.T.H. "K" FRANKSVILLE, WISCONSIN 53126
TEL. (262) 835-4774 FAX: (262) 835-2379

Sheet
1 of 1