

# Plat of Survey

A parcel of land located in the Southwest 1/4 of Section 26, Town 4 North, Range 16 East, Town of LaGrange, Walworth County, Wisconsin, described as follows:  
Commencing the the N.E. corner of Lot 22 Block 2, Green Lake Park a subdivision in Section 26, T4N, R16E, Walworth County, Wisconsin; thence S. 48°45' E., 39.90 feet to an iron stake, thence S. 64°56' E., 40.0 feet to an iron stake, thence S. 78°01' E., 65.0 feet to an iron stake, thence N. 88°14' E., 110.17 feet to an iron stake, thence S. 72°23' E. 42.65 feet to an iron stake, thence S. 63°39' E., 35.50 feet to an iron stake, thence S. 22°28' E., 78.07 feet to an iron stake, thence S. 2°07' W., 74.00 feet to the place of beginning of this description, thence S. 2°07' W., 65.65 feet to a point, thence S. 0°19' E., 141.79 feet to a point, thence S. 89°52' W., 196.70 feet to the shore of Green Lake, thence N'ly along the shore of Green Lake 175.0 feet more or less to a point that is 203.00 feet S. 79°43' W., from the place of beginning, thence N. 79°43' E., 203.00 feet to the place of beginning.

Surveyed for: **Patrick Costello**  
1021 Aegean Drive  
Schaumburg, Illinois. 60193

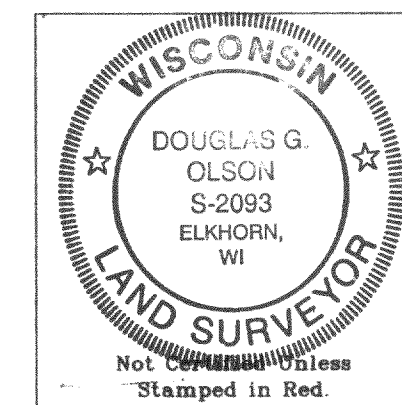
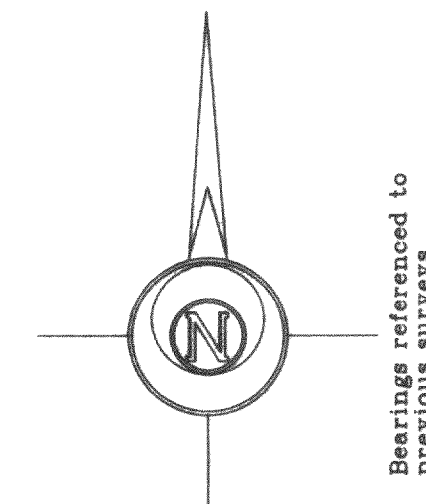

- Notes: 1) This survey plat is not certified unless signed and sealed in red ink.  
2) This survey is subject to Wisconsin lien laws. This Plat of Survey is the notice of intent to file lien. Lien waiver required.

Copyright © 2000 by Jensen & Olson Land Surveying, LLC

All rights reserved. No part of this survey plat may be reproduced or transmitted in any form by any means - graphic, electronic, or mechanical, including photocopying, tracing, or information storage and retrieval systems - without permission in writing from Douglas G. Olson, Jensen & Olson Land Surveying, LLC.

I, Douglas G. Olson, Wisconsin Registered Land Surveyor, do hereby certify that this survey was performed by me or under my direction in full compliance with the owner's/agent's instructions and Chapter A-E 7 of the Wisconsin Administrative Code "Minimum Standards for Property Surveys"; and that this map is an accurate representation thereof to the best of my knowledge and belief.

Douglas G. Olson  
Wisconsin Registered Land Surveyor - 2093

Survey Date: July 11, 2000.  
Revisions:

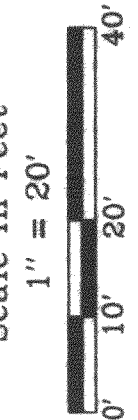

**Jensen & Olson Land Surveying, LLC**  
45 South Wisconsin Street  
P.O. Box 322  
Elkhorn, Wisconsin. 53121  
Telephone (262) 723-3434  
Facsimile (262) 723-8044

**Legend**  
Found Iron Pipe  
Recorded Information  
Utility Pedestal  
Concrete Surface  
Asphalt Surface

Sheet 1 of 1 Sheets  
Job Reference Number  
**2000.093**

**2000.093**

HGP-18M 416-1674