

# Plat of Survey

of

A parcel of land located in the Southwest 1/4 of Section 26, Town 4 North, Range 16 East, Town of LaGrange, Walworth County, Wisconsin, described as follows:  
Commencing at the N.E. corner of Lot 22 Block 2, Green Lake Park a subdivision in Section 26, T4N, R16E, Walworth County, Wisconsin; thence S. 48°45' E., 39.90 feet to an iron stake, thence S. 64°56' E., 40.0 feet to an iron stake, thence S. 78°01' E., 65.0 feet to an iron stake, thence N. 88°14' E., 110.17 feet to an iron stake, thence S. 72°23' E., 42.65 feet to an iron stake, thence S. 63°39' E., 35.50 feet to an iron stake, thence S. 22°28' E., 78.07 feet to an iron stake, thence S. 2°07' W., 74.00 feet to the place of beginning of this description, thence S. 2°07' W., 65.65 feet to a point, thence S. 0°19' E., 141.79 feet to a point, thence S. 89°52' W., 196.70 feet to the shore of Green Lake, thence N.W. along the shore of Green Lake 175.0 feet more or less to a point that is 203.00 feet S. 79°43' W. from the place of beginning, thence N. 79°43' E., 203.00 feet to the place of beginning.

Surveyed for: **Patrick Costello**  
1021 Aegean Drive  
Schaumburg, Illinois 60193

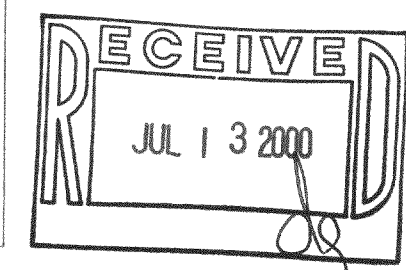
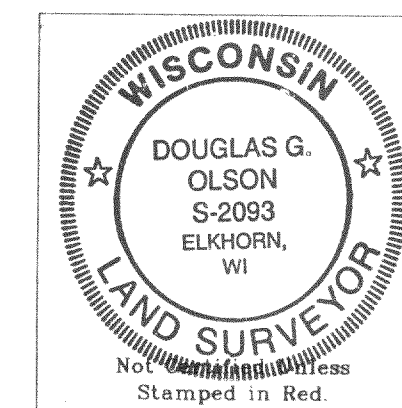
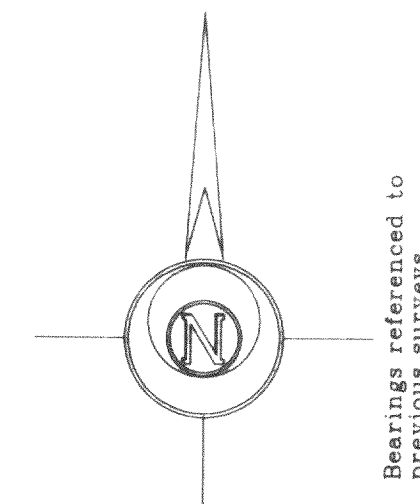

- Notes:
- 1) Existing paved surfaces are shown as recorded on previous surveys due to snow cover at the time of this survey.
  - 2) This survey plat is not certified unless signed and sealed in red ink.
  - 3) This survey is subject to Wisconsin lien laws. This Plat of Survey is the notice of intent to file lien. Lien waiver required.

Copyright © 2000 by Jensen & Olson Land Surveying, LLC.

All rights reserved. No part of this survey plat may be reproduced or transmitted in any form by any means - graphic, electronic, or mechanical, including photocopying, tracing, or information storage and retrieval systems - without permission in writing from Douglas G. Olson, Jensen & Olson Land Surveying, LLC.

I, Douglas G. Olson, Wisconsin Registered Land Surveyor, do hereby certify that this survey was performed by me or under my direction in full compliance with the owner's/agent's instructions and Chapter A-E 7 of the Wisconsin Administrative Code "Minimum Standards for Property Surveys"; and that this map is an accurate representation thereof to the best of my knowledge and belief.

*Douglas G. Olson*  
Douglas G. Olson  
Wisconsin Registered Land Surveyor - 2093

Survey Date: Feb 21, 2000  
Revisions:

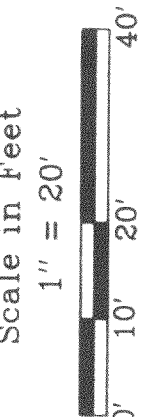

**Jensen & Olson Land Surveying, LLC**  
45 South Wisconsin Street  
Elkhorn, Wisconsin 53121  
P.O. Box 322  
Telephone (262) 723-3434  
Facsimile (262) 723-8044

**Legend**  
 Found Iron Pipe  
 Recorded Information  
 Utility Pedestal  
 Concrete Surface  
 Asphalt Surface

Sheet 1 of 1 Sheets  
Job Reference Number  
**2000.010**

2000.010

416-1590

HGP-18M