

Rt. 3, Box 273
Elkhorn, Wisconsin 53121
Phone: (414) 723-4260 (office)
(414) 723-7209 (FAX)

LOT 49 OF MARINER HILLS SUBDIVISION

LOCATED IN THE NORTHWEST 1/4 OF THE SOUTHWEST 1/4,
THE SOUTHWEST 1/4 OF THE SOUTHWEST 1/4, THE
SOUTHEAST 1/4 OF THE SOUTHWEST 1/4 AND THE
SOUTHWEST 1/4 OF THE SOUTHEAST 1/4 OF SECTION 34,
TOWN 4 NORTH, RANGE 16 EAST, WALWORTH COUNTY,
WISCONSIN.

ORDERED BY: SCHAUDER BUILDING, INC.
4115 HIGHWAY 51 NORTH
JANESVILLE, WISCONSIN
53545-9674

OWNERS: JIM KOPLINSKI AND MEREDITH KELLER
2080 EMERY CT. #8
EAST TROY, WI. 53120

THE ORIGINAL PLAT FOR MARINER HILLS STATES THAT LOT 49 IS REQUIRED TO HAVE A MOUND SOIL ABSORPTION SYSTEM UNLESS ADDITIONAL SOILS TEST SHOW OTHERWISE.

SUBDIVISION RECORDED IN CAB. B SLIDE 73
DOC. NO. 119734
SEPTEMBER 17, 1985



CURVE	ARC	DELTA	RADIUS	CHORD LENGTH	CHORD BEARING
C1	155.67	22°17'53"	400.00	154.69	S 72°21'00" E
C2	112.68	13°55'57"	463.37	112.40	S 72°32'00" E

Legend

- .Y FOUND IRON PIPE
 ● FOUND IRON ROD
 ○ FOUND BRASS CAPPED MONUMENT
 * FOUND CONCRETE MONUMENT
 + CHISEL CUT IN CONCRETE
 ● SET IRON ROD, 24" LONG, WEIGHING
 1.5 LBS., LINEAL FT., 3/4" DIA.
 ● SET IRON ROD, 30" LONG, WEIGHING
 4.5 LBS., LINEAL FT., 1-11/16" DIA.
 (xx) RECORDED AS DIMENSION
 —X—X— EXISTING FENCE

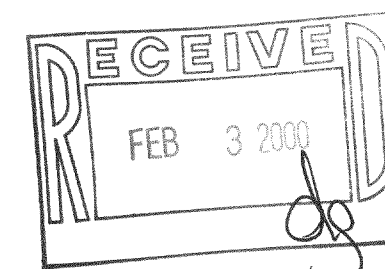

SCALE: 1"=30 FEET

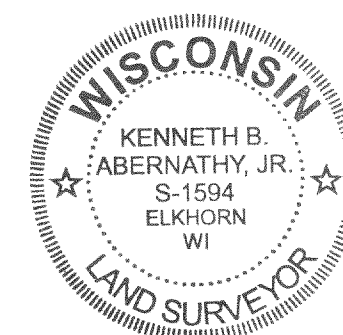

"I hereby certify that the above described property has been surveyed by me or under my direction and that the above map is a true and correct representation thereof and shows the size and location of the property, its exterior boundaries, the location of all visible structures and dimensions of all principal buildings thereon, boundary fences, apparent easements, roadways and visible encroachments, if any."

one year from date hereof."

Kenneth B. Abernathy.

KENNETH B. ABERNATHY, JR.
WISCONSIN REGISTERED LAND SURVEYOR
S-1594

Date: 9/13/99 Job No. 99-612

REVISED SEPTEMBER 13, 1999

416-1547

НМД - ца