

PLAT OF SURVEY

LEGAL DESCRIPTION

A PARCEL OF LAND LOCATED IN THE NORTHEAST 1/4 OF SECTION 35, TOWN 4 NORTH, RANGE 16 EAST, LAGRANGE TOWNSHIP, WALWORTH COUNTY, WISCONSIN AS DESCRIBED IN VOL. 502 OF RECORDS, PAGE 107, DOC. # 201862.

LOT 6 AND THE EASTERLY 24 FEET OF LOT 7 IN BLOCK 2 OF THAN'S LAND, AS PER PLAT THEREOF ON RECORD IN THE OFFICE OF THE REGISTER OF DEEDS FOR WALWORTH COUNTY, WISCONSIN; ALSO THE EASTERLY 74 FEET OF A PARCEL OF LAND AT THE REAR OF SAID LOTS AND LOT 8 ADJOINING, WHICH SAID PARCEL OF LAND IS BOUNDED AND DESCRIBED AS FOLLOWS, TO-WIT: BEGINNING AT THE SOUTHWEST CORNER OF SAID LOT 8 IN BLOCK 2 OF THAN'S LAND ABOVE MENTIONED; THENCE SOUTHERLY ON THE WESTERLY LINE OF SAID LOT 8, EXTENDED, 125 FEET; THENCE EASTERLY TO A POINT ON THE EASTERLY LINE OF SAID LOT 6, EXTENDED, WHICH IS 60 FEET TO THE SOUTHERLY FROM THE SOUTHEAST CORNER OF SAID LOT 6; THENCE NORTHERLY 60 FEET TO THE SOUTHEAST CORNER OF SAID LOT 6; THENCE WESTERLY ALONG THE SOUTHERLY LINES OF SAID LOTS 6, 7 AND 8 TO THE SOUTHWEST CORNER OF SAID LOT 8 AND POINT OF BEGINNING.

ORDERED BY: BILL KLEWIN
621 BOWERS BLVD.
DELAVAN, WI. 53115

OWNERS: ROBERT & CAROLE KRUSE

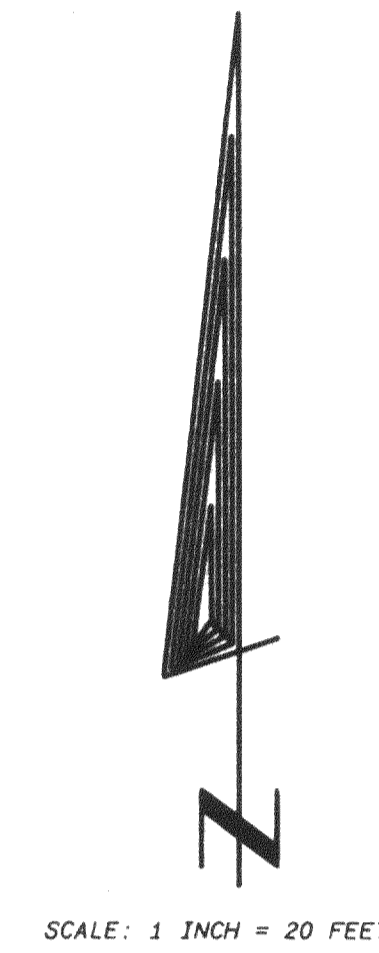

- Legend
- FOUND IRON PIPE
 - FOUND IRON ROD
 - FOUND BRASS CAPPED MONUMENT
 - FOUND CONCRETE MONUMENT
 - ✱ CHISEL CUT IN CONCRETE
 - SET IRON ROD, 24" LONG, WEIGHING 1.5 LBS., LINEAL FT., 3/4" DIA.
 - SET IRON ROD, 36" LONG, WEIGHING 4.5 LBS., LINEAL FT., 1-1/16" DIA.
 - (XX) RECORDED AS DIMENSION
 - - - - - EXISTING FENCE

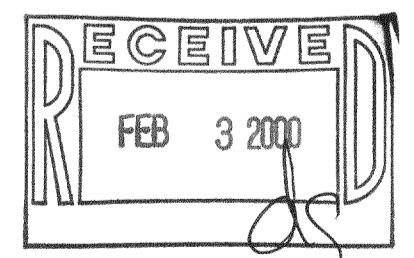
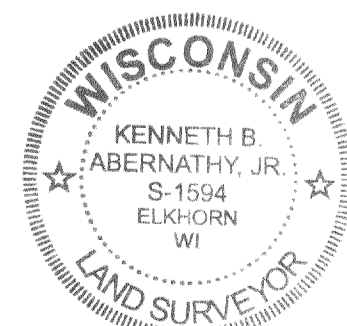

SCALE: 1"=20 FEET

I hereby certify that the above described property has been surveyed by me or under my direction and that the above map is a true representation thereof and shows the size and location of the property, its exterior boundaries, the location of all visible structures and dimensions of all principal buildings thereon, boundary fences, apparent easements, roadways and visible encroachments, if any. This survey is made for the use of the present owners of the property, and also those who purchase, mortgage or guarantee the title thereof within one year from date hereof.

Kenneth B. Abernathy, Jr.

KENNETH B. ABERNATHY, JR.
WISCONSIN REGISTERED LAND SURVEYOR,
S-1594

Date: 10-22-99 Job No. 99-912

HTL-17

416-1538