

Plat of Survey

of
Lot 20 of Green Lake Subdivision,
located in the Northwest 1/4 of Section 25, Town 4 North,
Range 16 East, Town of LaGrange, Walworth County, Wisconsin.

Surveyed for: **Michael J. Parent**
13025 Golf Parkway
Brookfield, Wisconsin. 53005

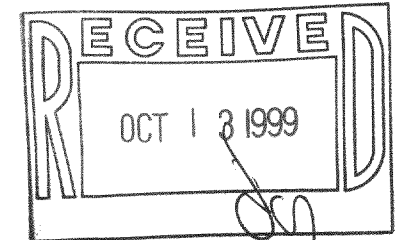

Note: The proposed house was staked as instructed by the owner.
All setbacks must be approved by the Building Inspector
PRIOR to construction.

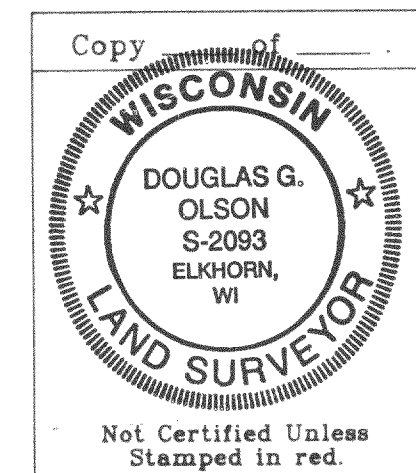
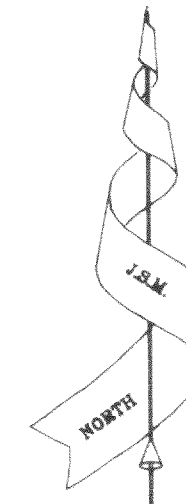

Note: This survey plat is not
certified unless signed
and sealed in red ink.

Note: This survey is subject to Wisconsin lien laws.
This Plat of Survey is the notice of intent
to file lien. Lien waiver required.

Copyright © 1999 by Jensen & Olson Land Surveying, LLC

All rights reserved. No part of this survey plat may be reproduced
or transmitted in any form by any means - graphic, electronic, or
mechanical, including photocopying, tracing, or information storage
and retrieval systems - without permission in writing from Douglas G.
Olson, Jensen & Olson Land Surveying, LLC.

I, Douglas G. Olson, Wisconsin Registered Land Surveyor, do
hereby certify that this survey was performed by me, or under my
direction in full compliance with the owner's / agent's instructions
and Chapter A-E 7 of the Wisconsin Administrative Code "Minimum
Standards for Property Surveys"; and that this map is as accurate
representation thereof to the best of my knowledge and belief.

Date: 9-15-99

Douglas G. Olson R.L.S. 2093

Mapping date: Sept. 15, 1999.

Revisions:

Scale in Feet

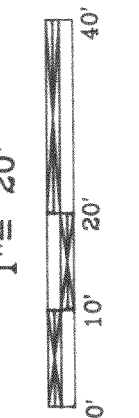

Jensen & Olson Land Surveying, LLC

45 South Wisconsin Street P.O. Box 322
Elkhorn, Wisconsin. 53121
Telephone: (414) 723-3434
Facsimile: (414) 723-8044

Legend

- Found Iron Rod
- () Recorded Information
- Utility Easement
- Asphalt Surface
- Set Wood Stake, 9-14-99

Sheet 1 of 1 Sheets.

Job Reference Number
1999.102

1999.102

HGS-20
416-1508