

## of

Surveyed for:

4207 North Sayre Street  
Norridge, Illinois 60634-1331

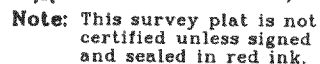

Copy \_\_\_\_\_ of \_\_\_\_\_.

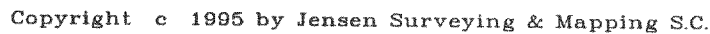

All rights reserved. No part of this survey plat may be reproduced or transmitted in any form by any means - graphic, electronic, or mechanical, including photocopying, tracing, or information storage and retrieval systems - without permission in writing from Thomas P.A. Jensen, Jensen Surveying & Mapping S.C..

I, Thomas P.A. Jensen, Wisconsin Registered Land Surveyor, do hereby certify that this survey was performed by me, or under my direction in full compliance with the owner's / agent's instructions and Chapter A-E 7 of the Wisconsin Administrative Code "Minimum Standards for Property Surveys"; and that this map is an accurate representation thereof to the best of my knowledge and belief.

Date: 0-7-93

Thomas P.A. Jensen R.L.S. 1084

✕ Found Iron Rod  
 ∅ Found Iron Pipe  
 ○ Set Iron Rod, 3/4" dia.  
 ( ) Recorded Dimension

**Telephone & Facsimile (414) 723-3434**

Scale in feet: 1" = 20'



Job Reference No.

1995.065

HB-52  
416-1260