

WORK ORDERED BY: CHARLES MADDEN
ROUTE 4
ELKHORN, WISCONSIN 53121

FARRIS, HANSEN & ASSOCIATES, INC.
Engineering, Architecture, Surveying
7 Highway Court, P.O. Box 437
Elkhorn, Wisconsin 53121
Office: (414) 723-2098
Fax: (414) 723-5886

REVISIONS

PROJECT NO.
4640
DATE
10/29/96
SHEET NO.
1 OF 1

BOUNDARY & TOPOGRAPHIC SURVEY

LOT 7 & PART OF LOT 8 OF BLOCK 1

GREEN LAKE PARK SUBDIVISION

LOCATED IN GOV'T LOT 5, SECTION 25, TOWN 4 NORTH, RANGE 16 EAST
WALWORTH COUNTY, WISCONSIN

LOT 7 AND LOT 8, BLOCK 1, GREEN LAKE SUBDIVISION, LOCATED IN GOVERNMENT LOT 5, SECTION 25, TOWN 4 NORTH, RANGE 16 EAST, WALWORTH COUNTY, WISCONSIN, EXCEPT BEGIN AT THE SOUTHWESTERLY CORNER OF SAID LOT 8; THENCE N 51DEG 45MIN E, 127.56 FEET MORE OR LESS ALONG THE WEST LINE OF LOT 8 TO THE SHORE OF GREEN LAKE; THENCE SOUTHEASTERLY ALONG THE SHORE, 25.00 FEET MORE OR LESS TO A POINT; THENCE S 52DEG 32MIN 46SEC W, 120.6 FEET MORE OR LESS TO THE PLIC ROAD; THENCE N 67DEG 00MIN W, 25.00 FEET TO THE POINT OF BEGINNING.

= FOUND IRON REBAR STAKE
= FOUND IRON PIPE STAKE
= RECORDED AS
VERTICAL DATUM: U.S.G.S. 1929 ADJ.

BENCH MARK
TOP OF IRON PIPE STAKE
EL. = 908.56'

BENCH MARK
TOP OF IRON REBAR STAKE
EL. = 888.77'

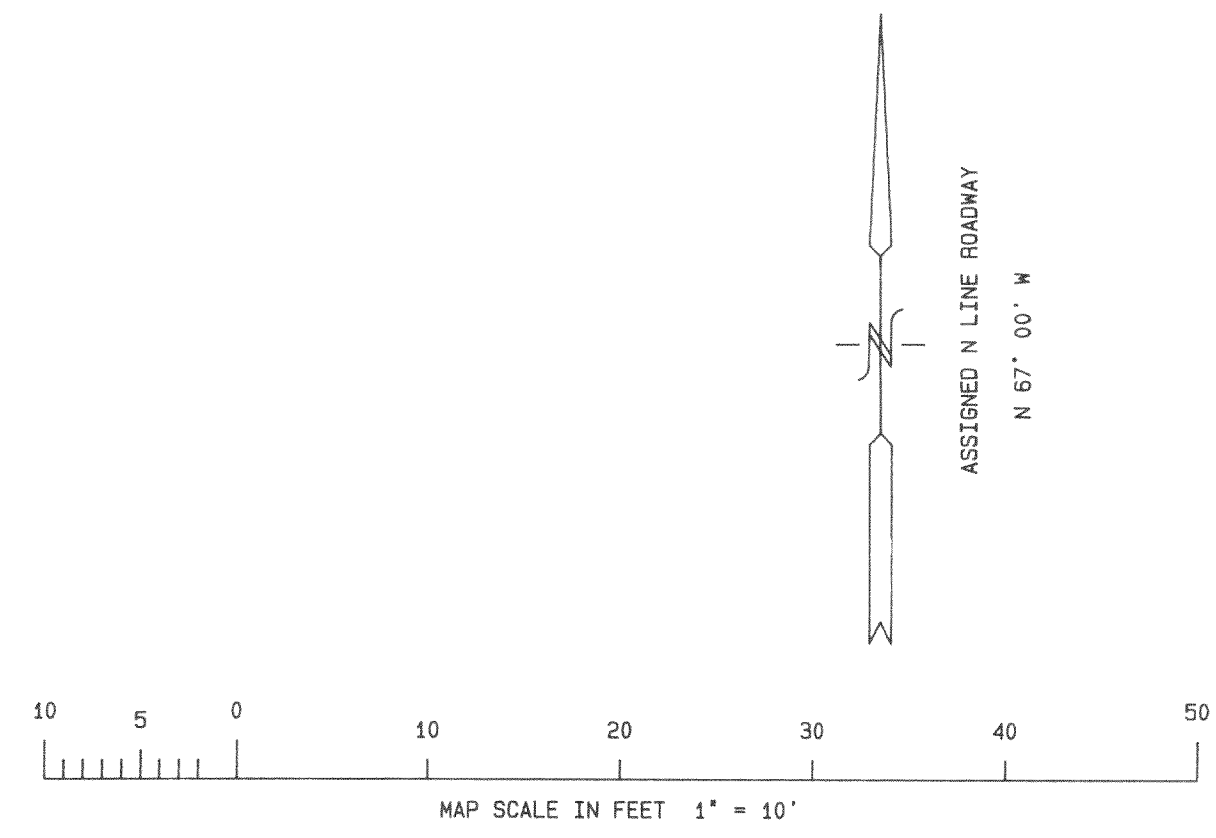

NOTE: COPIES OF THIS MAP TO WHICH THE FOLLOWING CERTIFICATE WILL APPLY ARE BLUE LINE PRINTS SHOWING SURVEYOR'S ORIGINAL SEAL AND SIGNATURE IN BLACK INK. COPIES BY ANY OTHER MEANS MAY HAVE ALTERATIONS WHICH DO NOT REPRESENT THE SURVEYOR'S WORK PRODUCT.

I HEREBY CERTIFY THAT THE ABOVE DESCRIBED PROPERTY HAS BEEN SURVEYED UNDER MY DIRECTION AND THAT THE ABOVE MAP IS A TRUE REPRESENTATION THEREOF AND SHOWS THE SIZE AND LOCATION OF THE PROPERTY AND ITS EXTERIOR BOUNDARIES. THIS SURVEY IS MADE FOR THE USE OF THE PRESENT OWNERS OF THE PROPERTY, AND ALSO THOSE WHO PURCHASE, MORTGAGE, OR GUARANTEE THE TITLE THERETO WITHIN ONE YEAR FROM THE DATE HEREOF.

DATED: 10/30/96

Peter S. Gordon
PETER S. GORDON R.L.S. 2101

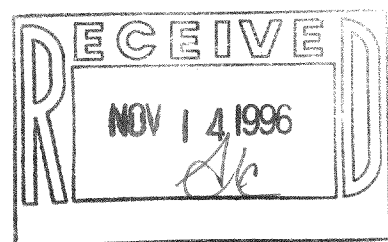
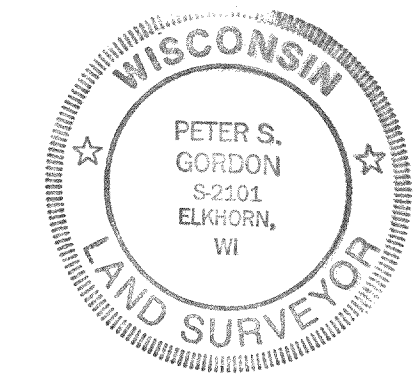

HGP-7

416-1226