

Green

Lake

Plat of Survey

of

Lot 20 and the Southwesterly 1/2 of Lot 21

(intending to describe that 1/2 of Lot 21 adjoining Lot 20 and extending from the highway to the lake shore)

in The First Addition to Lauderdale Park,

a subdivision located in Government Lot 4 in the Southwest 1/4 of Section 25,
Town 4 North, Range 16 East, Town of LaGrange, Walworth County, Wisconsin.

Surveyed for: **Keefe Real Estate, Inc.**

751 Geneva Parkway
Lake Geneva, Wisconsin. 53147



Bearings referenced to the Southwesterly line of Certified Survey Map No. 3719,
recorded as N37°20'44"W in the Wisconsin State Plane Coordinate System,
South Zone, (NAD-27).

Lot 1
C.S.M. 3719

Lot 21

Tax Parcel
HLPA 00008

0.314 Acre
13,674 Sq.Ft.

House
W5248
Lot 20

Garage

With lower level storage
& upper level living area

Lauderdale Drive

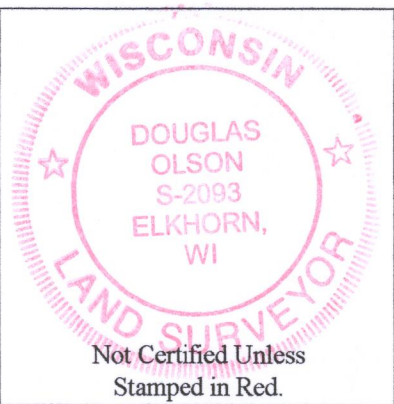

Notes:

- 1) This Plat of Survey is not certified unless signed and sealed in red ink.
- 2) This survey is subject to Wisconsin lien laws. This Plat of Survey is the notice of intent to file lien. Lien waiver required.
- 3) The Survey Date shown on this Plat of Survey is the completion date of the field work.

Copyright ©2018 by Olson Land Surveying, LLC.

All rights reserved. No part of this survey plat may be reproduced or transmitted in any form by any means - graphic, electronic, or mechanical, including photocopying, tracing, or information storage and retrieval systems - without permission in writing from Douglas G. Olson, Olson Land Surveying, LLC.

I hereby certify that I have surveyed the above described property in compliance with Chapter A-E 7 of the Wisconsin Administrative Code and that the map hereon is correct to the best of my professional knowledge and belief and shows the size and location of the property, its exterior boundaries, the location and dimensions of all visible structures thereon, boundary fences, apparent easements and roadways and visible encroachments, if any.

This survey is made for the exclusive use of the present owners of the property, and also those who purchase, mortgage or guarantee title thereto, within one year from the date hereof.

Douglas G. Olson
Wisconsin Professional Land Surveyor - 2093

HLPA-8 416-3056

Survey Date: September 6, 2018.

Revisions:

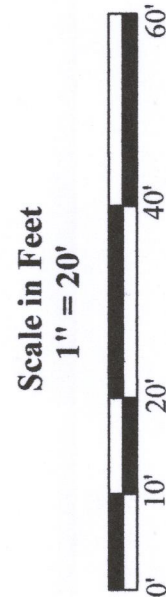

45 South Wisconsin Street | P.O. Box 322
Elkhorn, Wisconsin. 53121
Telephone: (262) 723-3434
Facsimile: (262) 723-8044
Email: doug@olsonsurveying.com
Website: www.olsonsurveying.com

OLSON
LAND SURVEYING, LLC
Rural | Residential | Commercial

Legend of Symbols & Abbreviations
Found Iron Pipe
Found Red Iron Pipe
Found Red Iron Spike
Set Mag Nail
Recorded Information
Utility Pole
Concrete Cover
Concrete Cover
Concrete Surface
Brick Pavers
North
South
East
West
Inches
Feet
Miles
Degrees
Minutes
Seconds
In Distances
In Feet
In Miles

Sheet 1 of 1 Sheets
Drawing Name
Job Reference Number
2018.123

2018.123