

Plat of Survey

of

Lot 14 and part of Lot 13 of Southmoor Subdivision,
located in the Southwest 1/4 of Section 25, Town 4 North, Range 16 East, Town of LaGrange,
Walworth County, Wisconsin.

Said part of Lot 13 described in a Warranty Claim Deed recorded April 14, 1998 in Vol. 653 on Page 7881 as Document
No. 379134 as shown below:
A portion of Lot 13 of Southmoor Subdivision, located in the SE 1/4 of the SW 1/4 and the SW 1/4 of the SW 1/4 of
Section 25, T. 4 N., R. 16 E., Walworth County, Wisconsin, described as follows: Commence at a found iron rod which
marks the Southwest corner of said Lot 13; thence N 0°22'00" W along the Westerly line of said Lot 13 and the Easterly
line of Laura Lane 75.75 feet to the point of beginning; thence continue N 0°22'00" W along said line 21.23 feet; thence
N 69°33'56" E along the Northerly line of said Lot 13, 328.30 feet; thence S 10°31'22" W along the Easterly line of said
Lot 13, 40.00 feet to a found iron rod; thence S 31°52'00" W along said Easterly line of said Lot 13, 97.98 feet to a
set iron rod; thence S 86°56'00" W 248.83 feet to the point of beginning.

Survey Date: October 25, 2010.
Revisions:

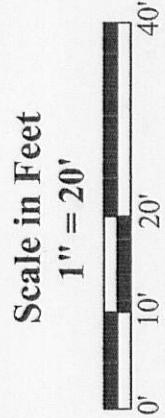

Jensen & Olson Land Surveying, LLC
45 South Wisconsin Street * P.O. Box 322 * Elkhorn, Wisconsin. 53121
Telephone: (262) 723-3434 * Facsimile: (262) 723-8044
Email: jensen.olson@elknet.net

Legend
Found Iron Pipe
Found Iron Rod
Recorded Information
Utility Pole or Pedestal
Utility Box or Septic Vent
Asphalt Surface
Concrete Surface

Sheet 1 of 1 Sheets
Drawing Name: elar16c2010110-2010110Plat.sjg
Job Reference Number
2010.110
2010.110

Laura Lane

(50' Wide)

N0°25'18"W 141.33'

12' Wide Utility Easement
As shown on the plat of
Southmoor Subdivision.

N46°50'56"E 99.32'

41' Building Setback line
As shown on the plat of
Southmoor Subdivision.

Overhead Wires
Guy
Found iron pipe
0.45' N42°20'56"W
of corner.

N0°19'30"W 76.83'
(N0°22'00"W 75.75')Deed

Southwest Corner
of Lot 13.

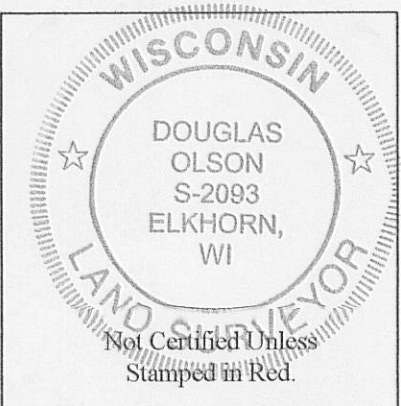

Proposed
Entry

Well

House
N7730

Lot 14

Tax Parcel
DSM 00014

1.256 Acres
54,696 Sq.Ft.

(N69°37'E 328.30')Plat
(N69°37°01"E 328.31'
(N69°33'56"E 328.30')Deed

North Line of Lot 13

Lot 13

S86°57'54"W 248.73'
(S86°56'00"W 248.83')Deed

Notes:

- 1) This survey plat is not certified unless signed and sealed in red ink.
- 2) This survey is subject to Wisconsin lien laws. This Plat of Survey is the notice of intent to file lien. Lien waiver required.

Lot 15

(S83°22'E 290.70')
S83°22'00"E 290.77'
75.00' Timber Retaining
Wall on Line

140.83'

S52°42'13"W 66.17'
(S52°46'W 66.13')

S10°41'58"W 40.24'
(S10°42'30"W 40')Plat
(S10°31'22"W 40.00')Deed

S31°59'06"W 97.69'
(S31°52'00"W 97.98')Deed

Lot 11

Surveyed for: Don Henderson
P.O. Box 776
Elkhorn, Wisconsin. 53121

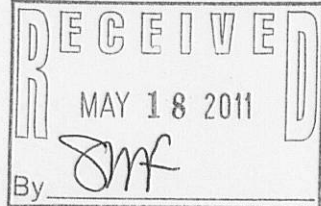
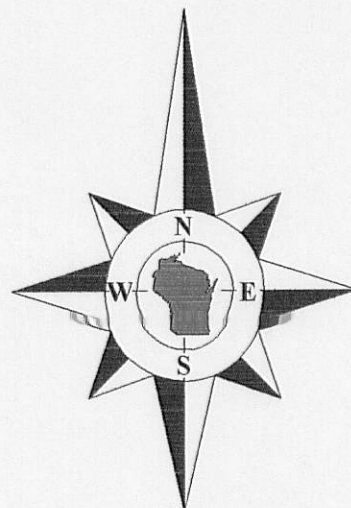

Copyright 2010 by Jensen & Olson Land Surveying, LLC.

All rights reserved. No part of this survey plat may be reproduced or transmitted in any form by any means - graphic, electronic, or mechanical, including photocopying, tracing, or information storage and retrieval systems - without permission in writing from Douglas G. Olson, Jensen & Olson Land Surveying, LLC.

I, Douglas G. Olson, Wisconsin Registered Land Surveyor, do hereby certify that this survey was performed by me, or under my direction in full compliance with the owner's/agent's instructions and Chapter A-E 7 of the Wisconsin Administrative Code "Minimum Standards for Property Surveys", and that this map is an accurate representation thereof to the best of my knowledge and belief.

Douglas G. Olson
Wisconsin Registered Land Surveyor - 2093

40M-14

410-9230

416-2530