

Oak Park Road
(33' Wide)

S 71°00'00" W 50.00'

Overhead Wires

Overhead Wires

Timber

Timber

Timber

Timber

Timber

Timber

Timber

Timber

Timber

S 26°59'00" E 108.65'

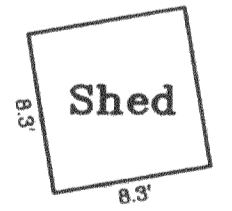

Tax Parcel
HOP 00015

Proposed
Garage

Timber

Timber

Timber

Timber

Timber

Timber

Timber

Timber

Timber

Timber

Retaining Wall

Retaining Wall

Retaining Wall

Retaining Wall

Retaining Wall

Retaining Wall

Retaining Wall

Retaining Wall

Retaining Wall

Retaining Wall

Fence is 0.3' SW. of pipe.

Fence on line.

Fence on line.

Fence on line.

Fence on line.

Fence on line.

Fence on line.

Fence on line.

Fence on line.

Fence on line.

Fence on line.

S 37°41'25" E

S 37°41'25" E

S 37°41'25" E

S 37°41'25" E

S 37°41'25" E

S 37°41'25" E

S 37°41'25" E

S 37°41'25" E

Wood Fence

Wood Fence

Wood Fence

Wood Fence

Wood Fence

Wood Fence

Wood Fence

Wood Fence

Lot 15

Lot 16

Lot 17

Lot 18

Property Exhibit

of
A Proposed Garage Location,
on a portion of

Lot 17 and part of Lot 16 of Oak Park,

a subdivision located in the Southeast 1/4 of Section 26, Town 4 North,
Range 16 East, Town of LaGrange, Walworth County, Wisconsin.

Described as follows:

All that certain piece of parcel of land lying and being in the plat of Oak Park, which plat is on record in the Register of Deeds office in and for Walworth County, Wisconsin, in vol. 6 of plats, on page 18, and being all of lot 17 and that part of lot 16, described as follows, to-wit: Being that part of lot 16 lying W'ly of a line drawn from the S.E.'ly corner of said lot 16 and passing through a stake on the base line of said plat, 27 ft. N.E.'ly of the point of intersecting of said base line with the W'ly line of said lot 16, and continuing on said line (from the N.E.'ly corner of said lot to the stake of the said base line) to the shore of Middle Lake at low water line, thence W'ly along the shore of said lake at low water line to the S.W.'ly corner of said lot 16, thence N.W.'ly on the W'ly line of said lot 16 to the place of beginning. Subsequent to July 27, 1923 - 8 A.M.

Prepared for: **Ted Drolshagen**
3738 West Coldspring Road
Greenfield, Wisconsin. 53221

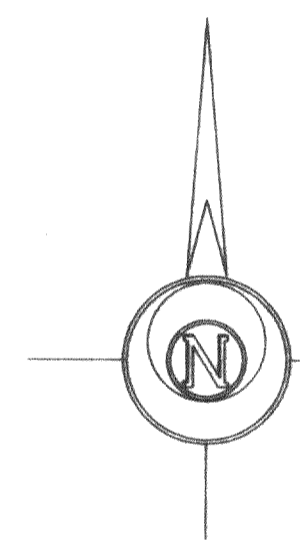

Bearings referenced to
the plat of Oak Park.

Note: The proposed garage is shown as instructed by the owner.
All setbacks must be approved by the building inspector
PRIOR to construction.

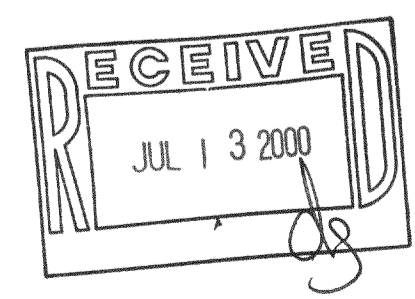

Survey Date: April 18, 2000.
Revisions:

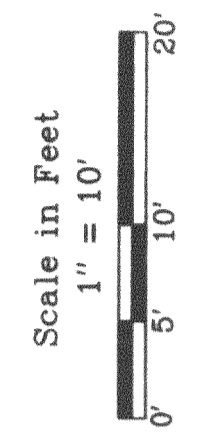

Jensen & Olson Land Surveying, LLC
45 South Wisconsin Street
Elkhorn, Wisconsin. 53121
Telephone (262) 723-3434
Facsimile (262) 723-8044

Legend
○ Found Iron Pipe
● Found Spike
✱ Set Iron Rod, 3/4" dia.
○ Recorded Information
✱ Utility Pole
□ Utility Pedestal
▭ Asphalt Surface
▨ Gravel Surface

Sheet 1 of 1 Sheets
Job Reference Number
2000.034

2000.034

HOP-15 416-1587