

PLAT OF SURVEY

Lot 11 of Hillview Park Subdivision, located in part of the Southeast 1/4 of the Northwest 1/4 of Section 35, Town 4 North, Range 16 East, Town of La Grange, County of Walworth, State of Wisconsin.

Middle Lake

Lot 10

Lot 11  
0.79 Acres ±

Lot 12

Hillview Drive  
66' Wide

Existing Concrete Foundation

Owners: Randy & Nancy Thelen  
Thelen Total Construction  
Post Office Box 17  
Elkhorn, Wisconsin 53121

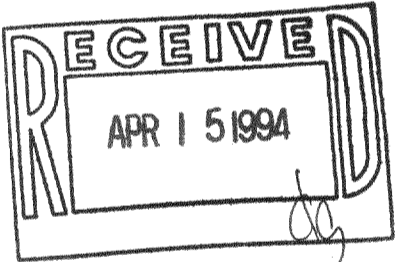

Legend

- ⊕ FOUND IRON PIPE
- ⊙ FOUND IRON ROD
- FOUND BRASS CAPPED MONUMENT
- FOUND CONCRETE MONUMENT
- + CHISEL CUT IN CONCRETE
- SET IRON ROD, 24" LONG, WEIGHING 1.5 LBS./LINEAL FT., 3/4" DIA.
- SET IRON ROD, 36" LONG, WEIGHING 4.5 LBS./LINEAL FT., 1-11/16" DIA.
- (\*\*\*) RECORDED AS DIMENSION
- - - - - EXISTING FENCE

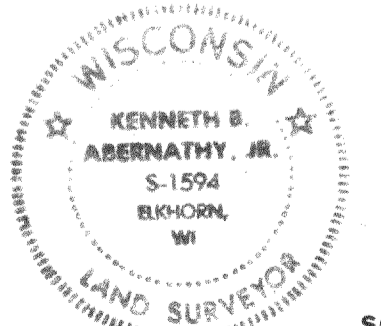

SCALE: 1" = 20 FEET

I hereby certify that the above described property has been surveyed by me or under my direction and that the above map is a true representation thereof and shows the size and location of the property, its exterior boundaries, the location of all visible structures and dimensions of all principal buildings thereon, boundary fences, apparent easements, roadways and visible encroachments, if any.  
This survey is made for the use of the present owners of the property, and also those who purchase, mortgage, or guarantee the title thereof within one year from date hereof.

*Kenneth B. Abernathy, Jr.*

KENNETH B. ABERNATHY, JR.  
WISCONSIN REGISTERED LAND SURVEYOR,  
S-1594

Date: February 4, 1994 Job No. 1994.202