

LAND-MARK SURVEYING

Mark L. Miritz

Wisconsin Registered Land Surveyor S-2582

N9330 Knuteson Drive
Whitewater, WI 53190
Phone: (262) 495-3284
FAX: (262) 495-8421
LAND-MARKSURVEYING.COM

PLAT OF SURVEY

LOT 29, BLOCK 2 OF INDIAN TRAIL SUBDIVISION,
LOCATED IN THE NORTHWEST 1/4 OF THE SOUTHWEST
1/4 OF SECTION 26 AND THE NORTHEAST 1/4 OF THE
SOUTHEAST 1/4 AND THE SOUTHEAST 1/4 OF THE
SOUTHEAST 1/4 OF SECTION 27, TOWN 4 NORTH,
RANGE 15 EAST, WHITEWATER TOWNSHIP,
WALWORTH COUNTY, WISCONSIN.

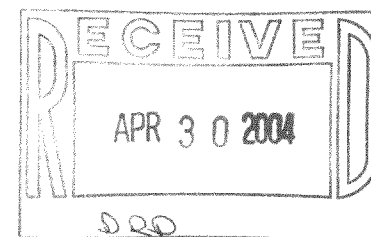

LOT 28

LOT 29

25,071 SQ. FT.

RESIDENCE

GARAGE

RICE

LAKE

LEGEND

- FOUND IRON PIPE
- FOUND IRON ROD
- FOUND COUNTY MONUMENT
- FOUND CONCRETE MONUMENT
- CHISEL CUT IN CONCRETE
- SET IRON ROD, 24" LONG, WEIGHING 1.5 LBS./LINEAL FT., 3/4" DIA.
- RECORDED AS DIMENSION
- EXISTING FENCE

THE SOUTHWESTERLY LINE OF LOT 29 WAS ASSUMED TO BEAR N 29°21' W

OWNERS: GERALD & SUSAN MILLIN
N7°52' N. KETTLE MORaine DR.
WHITEWATER, WI 53190

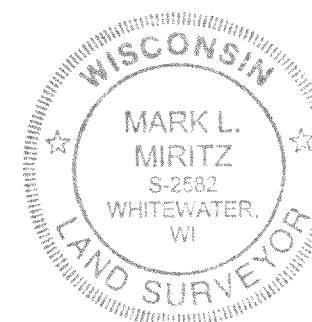

SCALE: 1" = 30 FEET

"I hereby certify that the above described property has been surveyed by me or under my direction and that the above map is a true representation thereof and shows the size and location of the property, its exterior boundaries, the location of all visible structures and dimensions of all principal buildings thereon, boundary fences, apparent easements, roadways and visible encroachments, if any."
"This survey is made for the use of the present owners of the property, and also those who purchase, mortgage, or guarantee the title thereto within one year from date hereof."

Mark L. Miritz
MARK L. MIRITZ
WISCONSIN REGISTERED
LAND SURVEYOR S-2582

DATE: APRIL 25, 2004 JOB NO. 04.405

DITS 00053

415-955