

PLAT OF SURVEY

TWO PARCELS OF LAND LOCATED IN THE NORTHWEST 1/4 OF THE SOUTHWEST 1/4 OF SECTION 9, AND OUTLOT 1 OF CERTIFIED SURVEY MAP NO. 724 AS RECORDED IN VOL. 3 AS PAGE 233 AND 234 AS DOCUMENT NO. 24824 ALSO LOCATED IN SECTION 9, TOWN 4 NORTH, RANGE 15 EAST, WALWORTH COUNTY, WISCONSIN.

WEST 1/4 CORNER
SEC. 9-4-15

fd. conc. monument

WEST LINE OF THE SOUTHWEST
1/4 OF SEC. 9-4-15

- 1319.37' -

fd. conc. monument

SOUTHWEST CORNER OF
THE NORTHWEST 1/4 OF
THE SOUTHWEST 1/4.
SEC. 9-4-15

PARCEL 1
1.35 AC.

PARCEL 2
1.83 AC.

OUTLOT 1
C.S.M. # 724
1.21 AC.

LEGAL DESCRIPTION

QUIT CLAIM DEED FROM MEDUSA PORTLAND CEMENT CO. TO JANESVILLE SAND AND GRAVEL CO. DATED APRIL 28, 1966 RECORDED IN VOL. 633 PAGE 271.

(PROVIDED BY CLIENT)

OWNED BY: JANESVILLE SAND AND GRAVEL CO.
P.O. BOX 427
711 HARDING ST.
JANESVILLE, WI. 53545

CENTER OF SECTION
SEC. 9-4-15

fd. conc. monument

fd. iron pipe is S
28°39'22"W 0.56' from
true corner



SCALE 1" = 30 FEET

Legend

- FOUND IRON PIPE
- FOUND IRON ROD
- FOUND BRASS CAPPED MONUMENT
- FOUND CONCRETE MONUMENT
- CHISEL CUT IN CONCRETE
- SET IRON ROD, 24" LONG, WEIGHING 1.5 LBS. LINEAL FT., 3/4" DIA.
- SET IRON ROD, 30" LONG, WEIGHING 4.5 LBS. LINEAL FT., 1 1/16" DIA.
- RECORDED AS DIMENSION
- EXISTING FENCE

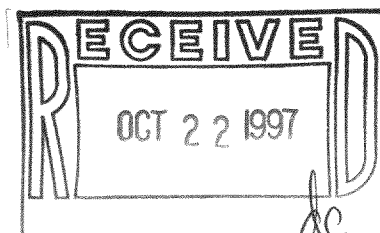

SCALE: 1" = 30 FEET

I hereby certify that the above described property has been surveyed by me or under my direction and that the above map is a true representation thereof and shows the size and location of the property, its exterior boundaries, the location of all visible structures, and dimensions of all principal buildings thereon, boundary fences, easements, roadways and visible encroachments, if any.

This survey is made for the use of the present owners of the property and also those who purchase, mortgage, or guarantee the title thereto within one year from date hereof.

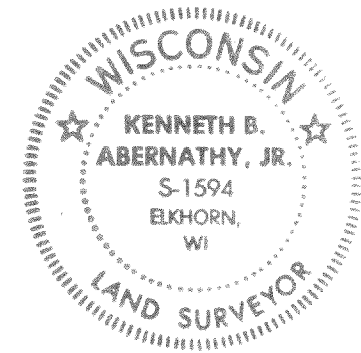

KENNETH B. ABERNATHY, JR.
WISCONSIN REGISTERED LAND SURVEYOR,
S-1594

Date: OCT 22 1997 Job No. 941020

PLAT OF SURVEY REVISED ON 9/30/97 TO SHOW THE ADDITION OF OUTLOT 1 OF C.S.M. # 724. BUILDINGS ON PARCEL 1 AND 2 HAVE CHANGED AND WERE NOT RELOCATED BY AGREEMENT WITH OWNER.

DA-724-1
DW-9-4A 415-623