

Plat of Survey

of
Lot 5 of Blue Heron Hills, A Subdivision,
located in the Northeast 1/4 of the Southeast 1/4 of Section 35, Town 4 North,
Range 15 East, Town of Whitewater, Walworth County, Wisconsin.

Surveyed for: **Zach & Trisha Renji**
108 Olsen Street
Elkhorn, Wisconsin. 53121

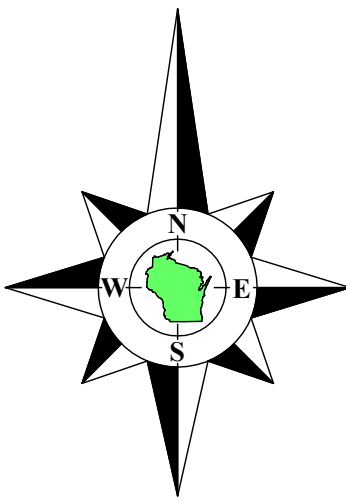

Bearings referenced to the long chord bearing of curve 16 on the
South line of Blue Heron Drive, recorded as S41°35'46"E on the
plat of Blue Heron Hills, A Subdivision.

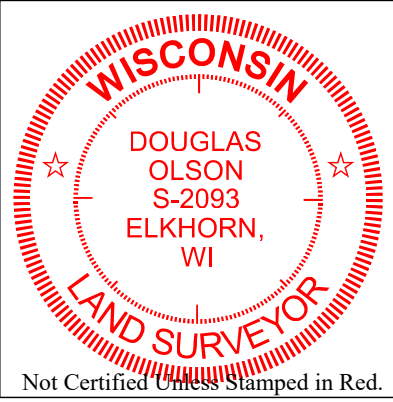

- Notes:**
- 1) This Plat of Survey is not certified unless signed and sealed in red ink.
 - 2) This survey is subject to Wisconsin lien laws. This Plat of Survey is the notice of intent to file lien. Lien waiver required.
 - 3) The Survey Date shown on this Plat of Survey is the completion date of the field work.

Copyright © 2023 by Olson Land Surveying, LLC.
All rights reserved. No part of this survey plat may be reproduced or transmitted in any form by any means - graphic, electronic, or mechanical, including photocopying, tracing, or information storage and retrieval systems - without permission in writing from Douglas G. Olson, Olson Land Surveying, LLC.

I hereby certify that I have surveyed the above described property in compliance with Chapter A-E 7 of the Wisconsin Administrative Code and that the map hereon is correct to the best of my professional knowledge and belief and shows the size and location of the property, its exterior boundaries, the location and dimensions of all visible structures thereon, boundary fences, apparent easements and roadways and visible encroachments, if any.
This survey is made for the exclusive use of the present owners of the property, and also those who purchase, mortgage or guarantee title thereto, within one year from the date hereof.

Douglas G. Olson
Wisconsin Professional Land Surveyor - 2093

2023.075	Sheet 1 of 1 Sheets	Legend of Symbols & Abbreviations ■ Pound County Section Corner ● Found Iron Pipe ● Found Iron Rod, 1-3/16" dia. ○ Found Iron Rod, 3/4" dia. () Recorded Information ⊗ Utility Pole ⊗ Utility Box or Pedestal ⊗ Concrete Cover ⊗ Septic Vent ⊗ Asphalt Surface ⊗ Concrete Surface ⊗ Gravel Surface ⊗ Brick Pavers N North S South E East W West In Bearings ° Degrees ' Minutes " Seconds In Distances Feet No. Number NW Northwest NE Northeast Dia. Diameter	 OLSON LAND SURVEYING, LLC Rural Residential Commercial	45 South Wisconsin Street P.O. Box 322 Elkhorn, Wisconsin. 53121 Telephone: (262) 723-3434 Facsimile: (262) 723-8044 Email: doug@olsonsurveying.com Website: www.olsonsurveying.com	Scale in Feet 1" = 20' 	Survey date: August 31, 2023. Revisions:
	Drawing Name: Job Reference Number 2023.075					