

Plat of Survey

of

Lot 10 of Block 1 of Moraine Heights,

a subdivision located in Government Lot 3 in the Southeast 1/4 of Section 26, Town 4 North, Range 15 East, Town of Whitewater, Walworth County, Wisconsin.

Surveyed for: **Todd & Kristine Zinkgraf**

N7698 Woodchuck Alley
Whitewater, Wisconsin. 53190

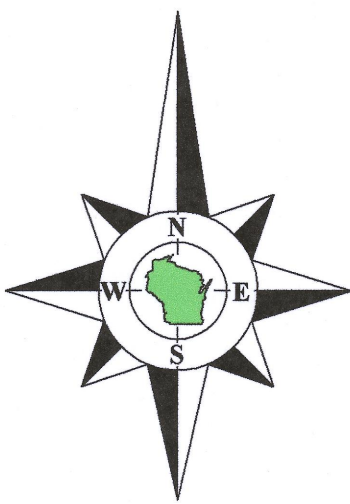

Bearings reference to the plat of Moraine Heights.

House
N7714

Deck

Whitewater
Lake

Lot 9
Moraine Heights

Tax Parcel
DMH 00009

Unimproved
"Public Road"
(50' Wide)

Woodchuck Alley
(East Ridge Road)

"Park"

Whitewater
Lake

Lake

Lot 10

Tax Parcel
DMH 00010
0.249 Acre
10,867 Sq.Ft.

Garage

Driveway

Lot 11
Moraine Heights

Tax Parcel
DMH 00011

Lot 12
Moraine Heights

House
N7694
Porch
Under Deck

Whitewater
Lake

Lake

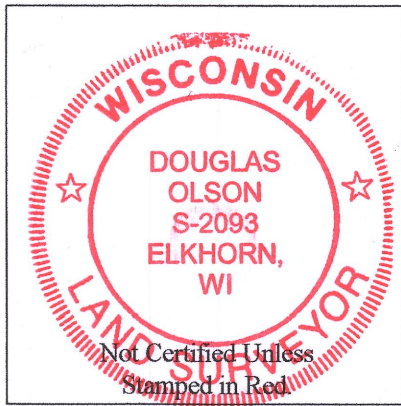

Notes:

- This survey plat is not certified unless signed and sealed in red ink.
- This survey is subject to Wisconsin lien laws. This Plat of Survey is the notice of intent to file lien. Lien waiver required.

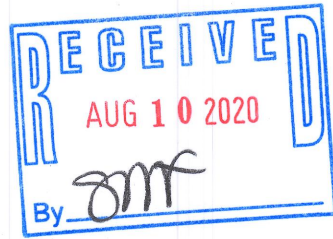

Copyright 2016 by Olson Land Surveying, LLC.

All rights reserved. No part of this survey plat may be reproduced or transmitted in any form by any means - graphic, electronic, or mechanical, including photocopying, tracing, or information storage and retrieval systems - without permission in writing from Douglas G. Olson, Olson Land Surveying, LLC.

I, Douglas G. Olson, Wisconsin Professional Land Surveyor, do hereby certify that this survey was performed by me, or under my direction in full compliance with the owner's/agent's instructions and Chapter A-E 7 of the Wisconsin Administrative Code "Minimum Standards for Property Surveys", and that this map is an accurate representation thereof to the best of my knowledge and belief.

Douglas G. Olson
Wisconsin Professional Land Surveyor - 2093

Sheet 1 of 1 Sheets

Drawing Name:

Job Reference Number
2020.085

Legend of Symbols & Abbreviations

- Found Iron Pipe
- Found Iron Rod
- Recorded Information
- Utility Pedestal
- Concrete Cover
- Septic Vent
- Lamp
- Asphalt Surface
- Gravel Surface

N North
S South
E East
W West
In Bearings
° Degrees
' Minutes
" Seconds
In Distances
' Feet
" Inches



45 South Wisconsin Street | P.O. Box 322
Elkhorn, Wisconsin. 53121
Telephone: (262) 723-3434
Facsimile: (262) 723-8044
Email: doug@olsonsurveying.com
Website: www.olsonsurveying.com

Scale in Feet
1" = 20'



Survey Date: July 19, 2006.

- Revisions: No. 1 - Adjacent houses and shoreyard setbacks, Proposed Garage & Deck.
No. 2 - Proposed Garage location
No. 3 - Garage Under Construction
No. 4 - New Driveway

2020.085

DMH-10

415-1505