

Plat of Survey

of

Lot 3 in Block 3 of Moraine Park Subdivision,

located in the Southwest 1/4 of the Northeast 1/4 of Section 34, Town 4 North,
Range 15 East, Town of Whitewater, Walworth County, Wisconsin.

Surveyed for: **Charles Hatchett**
N7541 West Lakeshore Drive
Whitewater, Wisconsin. 53190

Lot 1
C.S.M. 2788

Lot 3
Tax Parcel
DMP 00036
0.548 Acre
23,850 Sq.Ft.

House
N7541

Burr Oak Drive
(50' Wide)

West Lake Shore Drive
(50' Wide)



Bearings reference to the plat of Moraine Park Subdivision as shown on prior surveys of record. A rotation of -0°27'33" from the Wisconsin State Plane Coordinate System, South Zone, (NAD-27).

Coordinates are referenced to the Wisconsin State Plane Coordinate System, South Zone, (NAD-27).

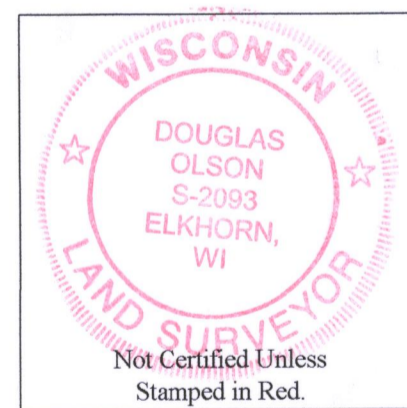

Notes:

- 1) This Plat of Survey is not certified unless signed and sealed in red ink.
- 2) This survey is subject to Wisconsin lien laws. This Plat of Survey is the notice of intent to file lien. Lien waiver required.
- 3) The Survey Date shown on this Plat of Survey is the completion date of the field work.

I hereby certify that I have surveyed the above described property in compliance with Chapter A-E 7 of the Wisconsin Administrative Code and that the map hereon is correct to the best of my professional knowledge and belief and shows the size and location of the property, its exterior boundaries, the location and dimensions of all visible structures thereon, boundary fences, apparent easements and roadways and visible encroachments, if any.

This survey is made for the exclusive use of the present owners of the property, and also those who purchase, mortgage or guarantee title thereto, within one year from the date hereof.

Douglas G. Olson
Wisconsin Professional Land Surveyor - 2093

Copyright ©2018 by Olson Land Surveying, LLC.

All rights reserved. No part of this survey plat may be reproduced or transmitted in any form by any means - graphic, electronic, or mechanical, including photocopying, tracing, or information storage and retrieval systems - without permission in writing from Douglas G. Olson, Olson Land Surveying, LLC.

Witness Corner
Section 34-4-15
N. 280.747.59
E. 2,348,299.25

Survey Date: June 6, 2018.
Revisions:

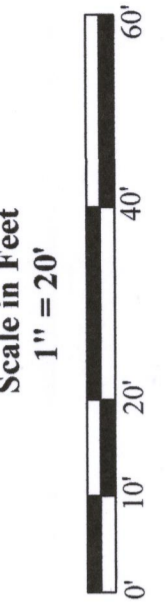

45 South Wisconsin Street | P.O. Box 322
Elkhorn, Wisconsin. 53121
Telephone: (262) 723-3434
Facsimile: (262) 723-8044
Email: doug@olsonsurveying.com
Website: www.olsonsurveying.com

OLSON
LAND SURVEYING, LLC
Rural | Residential | Commercial

Legend of Symbols & Abbreviations
N North
S South
E East
W West
In Bearings
In Distances
In Feet
In Inches
Found County Section Corner
Found Iron Pipe, 1" dia.
Set Iron Pipe, 1" dia.
Recorded Information
Utility Pole
Utility Vent
Concrete Cover
Concrete Surface
Brick Pavers

Sheet 1 of 1 Sheets
Drawing Name:
Job Reference Number
2018.060

2018.060

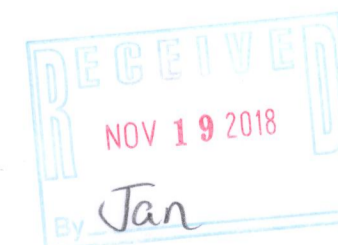

DMP-36 415-1471