

PLAT OF SURVEY

OUT LOT ONE, COUNTRY ACRES, BEING A PART OF THE NORTHWEST 1/4 OF SECTION 25, TOWN 4 NORTH, RANGE 15 EAST, WALWORTH COUNTY, WISCONSIN.

SURVEYED FOR: ARTHUR THOMPSON
SURVEY ADDRESS: N8090 KRISTY LANE

NORTHWEST CORNER OF THE NORTHWEST 1/4 OF SECTION 25-4-15

(N87°37'05"E)
N87°44'04"E
(257.90')
257.90'
NORTH LINE OF THE NORTHWEST 1/4 OF SECTION 25-4-15

WEST LINE OF THE NORTHWEST 1/4 OF SECTION 25-4-15
N00°02'30"W
(212.00')
212.00'

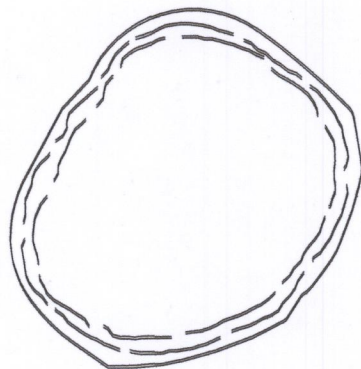

POND LOCATION PER WALWORTH CO. G.I.S., CURRENTLY DRY.

EXISTING SHED
6.0'X6.7'

EXISTING SHED
8.2'X12.2'

84927 SQ. FT.
1.95 ACRES

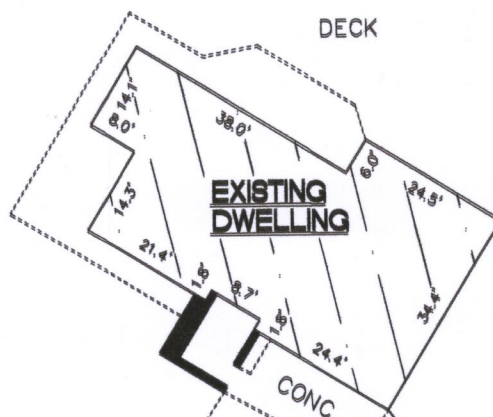

EXISTING DWELLING

SEPTIC LID

SEPTIC VENT

UTILITY BOXES

WELL

ASPHALT DRIVEWAY

EXISTING BUILDING

OVERHANG

N65°59'23"W
(S86°02'55"E)

250.65'
(250.18')

229.38'
(229.23')

EDGE OF PAVEMENT

KRISTY

LANE

M. Thompson
MARILYN THOMPSON: CLIENT

MONUMENTATION WAS WAIVED BY CLIENT IN ACCORDANCE WITH A-E7.01(2) OF THE WISCONSIN ADMINISTRATIVE CODE.

SCALE 1"=30'

15' 0' 15' 30' 60'

BEARINGS ARE REFERENCED TO THE WEST LINE OF THE NORTHWEST 1/4 OF SECTION 25-4-15 AND IS ASSUMED TO BEAR N00°02'30"W.

MEASURED CURVE DATA

RADIUS	LENGTH	CHORD	BEARING	DELTA
133.00'	229.38'	201.99'	S56°03'55"W	98°48'54"

RECORDED CURVE DATA

RADIUS	LENGTH	CHORD	BEARING	DELTA
133.00'	229.23'	201.89'	S56°08'33"W	98°45'06"

- FOUND 6" CONC. MON. W/BRASS CAP
- FOUND 2" O.D. IRON PIPE
- FOUND 1 1/4" O.D. IRON PIPE
- () RECORDED AS DIMENSIONS

"I hereby certify that I have surveyed the above property and that the above map is a true representation thereof and shows the size and location of the property, its exterior boundaries, the location of all visible structures and dimensions of all principal buildings thereon, boundary fences, apparent easements, roadways and encroachments if any."

"This survey is made for the use of the present owners of the property, and also those who purchase, mortgage or guarantee the title thereto within one year from date hereof."

THIS IS NOT AN ORIGINAL SURVEY UNLESS THE SEAL IS RED.

REV. 1/29/18
10/5/17
DATE

TEP
FIELD WORK BY

TEP
DRAWN BY

17119
JOB NUMBER

Kettle Moraine Surveying Inc.
P.O. Box 357
Eagle WI. 53119
(262)594-3484
kettlemorainesurveying.com

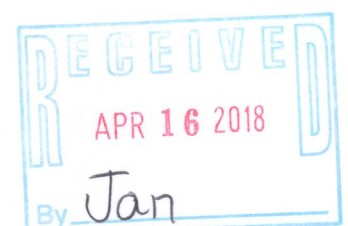
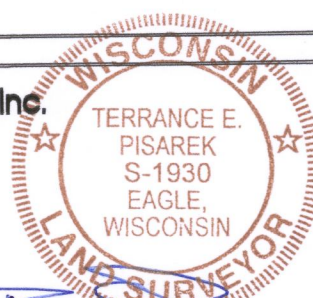

DCM-11

415-1447