

Plat of Survey

of

Lot 2 of Certified Survey Map No. 1934,

recorded in Vol. 9 of Certified Survey Maps of Walworth County on Page 152 and located in the Southeast 1/4 of Section 34, Town 4 North, Range 15 East, Town of Whitewater, Walworth County, Wisconsin.

Surveyed for: **James Bronson**
N7470 Kettle Moraine Drive
Whitewater, Wisconsin 53190



Bearings reference to Certified Survey Map No. 1934.

Scale in Feet

1" = 20'

Olson Land Surveying, LLC

45 South Wisconsin Street * P.O. Box 322 * Elkhorn, Wisconsin. 53121

Telephone: (262) 723-3434 * Facsimile: (262) 723-8044



Legend

- Found Iron Pipe
- Found Iron Rod
- Set Iron Pipe, 1" dia.
- Set Iron Rod, 1" dia.
- Record Information
- Utility Pole
- Utility Pedestal
- Concrete Cover
- Deciduous Tree

Sheet 1 of 1 Sheets

Job Reference Number

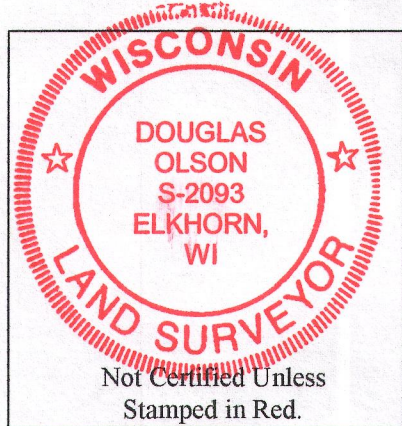

Notes:

- This survey plat is not certified unless signed and sealed in red ink.
- This survey is subject to Wisconsin lien laws. This Plat of Survey is the notice of intent to file lien. Lien waiver required.

Copyright 2015 by Olson Land Surveying, LLC.

All rights reserved. No part of this survey plat may be reproduced or transmitted in any form by any means - graphic, electronic, or mechanical, including photocopying, tracing, or information storage and retrieval systems - without permission in writing from Douglas G. Olson, Olson Land Surveying, LLC.

I, Douglas G. Olson, Wisconsin Professional Land Surveyor, do hereby certify that this survey was performed by me, or under my direction in full compliance with the owner's/agent's instructions and Chapter A-E 7 of the Wisconsin Administrative Code "Minimum Standards for Property Surveys"; and that this map is an accurate representation thereof to the best of my knowledge and belief.

Douglas G. Olson
Wisconsin Professional Land Surveyor - 2093

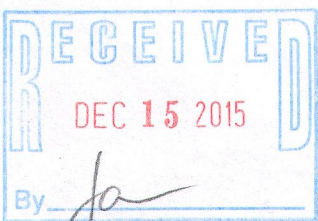

Whitewater

Lake