



Bearings referenced to the plat of Minnieska Subdivision.

Whitewater Lake

Lake Elevation
Taken August 2, 2013
872.10

Average Setback of Adjacent Houses

- 71.1' - Lot 2, Block 1 Minnieska
- 53.6' - Tax Parcel DW 3500003
- 62.4' - Average Setback

Average Setback of Adjacent Houses within 250'

- 62.4' - Lot 4, Block 1 Minnieska
- 90.7' - Lot 3, Block 1 Minnieska
- 71.1' - Lot 2, Block 1 Minnieska
- 53.6' - Tax Parcel DW 3500003
- 95.1' - Tax Parcel DW 3500004
- 111.2' - Tax Parcel DW 3500002B
- 80.7' - Average Setback

Plat of Survey

of

Lot 1 of Block 1 of Minnieska Subdivision,

located in the Northeast 1/4 of Section 35, Town 4 North, Range 15 East, Town of Whitewater, Walworth County, Wisconsin.

EXCEPT FOR the following described parcel of real estate, A parcel of land, being part of Lot 1, Block 1 of Minnieska Subdivision, located in Section 35, T 4 N, R 15 E, Town of Whitewater, Walworth County, Wisconsin and described as follows: Commence at the Northeast corner of said Lot 1; thence North 66°32' West, along the North line of said Lot 1, 14.16 feet to a 3/4" iron rod which marks the point of beginning of this description; thence N74°22'W, parallel with and 3 feet South of the South wall of a garage, 48.69 feet to a 3/4" iron rod; thence North 14°19' East, parallel with and 3 feet West of the West wall of a garage, 6.72 feet to a 3/4" iron rod on the North line of said Lot 1; thence South 66°32' East, along said North line, 49.30 feet to the point of beginning.

Warranty Deed recorded July 7, 2008 as Document No. 740615.

Surveyed for: **Larry & Judy Loizzo**
434 Winnebago Drive
Janesville, Wisconsin. 53548

Survey Date: August 21, 2009.
Revisions: No. 1 - Adjacent Houses & 62.4' Setback line
No. 2 - 80.7' Setback line
No. 3 - From Adjacent Houses within 250' & Proposed Additions

Scale in Feet
1" = 20'

Jensen & Olson Land Surveying, LLC

45 South Wisconsin Street * P.O. Box 322 * Elkhorn, Wisconsin. 53121
Telephone: (262) 723-3434 * Facsimile: (262) 723-8044
Email: jensen.olson@elknet.net

Legend
Found Iron Pipe, 1" dia, unless noted
Found Iron Rod, 3/4" dia, noted
Recorded Information
Utility Pole
Concrete Cover
Asphalt Surface
Concrete Surface

Sheet 1 of 2 Sheets
Drawing Name: 44415-2012130-20121301292.dwg
Job Reference Number
2012.130

2012.130

Copyright 2009 by Jensen & Olson Land Surveying, LLC.

All rights reserved. No part of this survey plat may be reproduced or transmitted in any form by any means - graphic, electronic, or mechanical, including photocopying, tracing, or information storage and retrieval systems - without permission in writing from Douglas G. Olson, Jensen & Olson Land Surveying, LLC.

I, Douglas G. Olson, Wisconsin Registered Land Surveyor, do hereby certify that this survey was performed by me, or under my direction in full compliance with the owner's/agent's instructions and Chapter A-E 7 of the Wisconsin Administrative Code "Minimum Standards for Property Surveys", and that this map is an accurate representation thereof to the best of my knowledge and belief.

Douglas G. Olson
Wisconsin Registered Land Surveyor - 2093

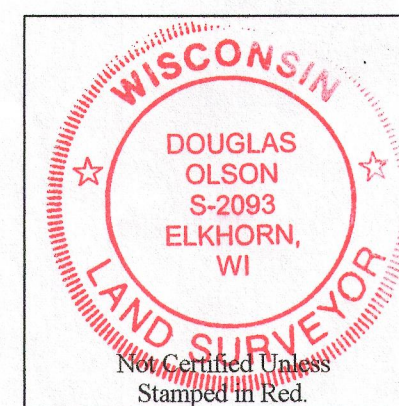

Tax Parcel
DW 3500005



Notes:

- This survey plat is not certified unless signed and sealed in red ink.
- This survey is subject to Wisconsin lien laws. This Plat of Survey is the notice of intent to file lien. Lien waiver required.
- Elevations referenced to Benchmark No. LRK-75, a Railroad Commission brass cap at the Southwest Corner of the bridge deck over the spillway to Rice Lake. Elevation recorded as 875.755.

415-1292