

Plat of Survey

of

Lot 23 of Oak Knoll,

a subdivision located in the Southeast 1/4 of Section 34, Town 4 North, Range 15 East, Town of Whitewater, Walworth County, Wisconsin.

Also

Lands described as Parcel A in a Quit Claim Deed recorded February 22, 2013 as Document No. 857807 as shown below:

Beginning at the Northwest corner of Lot 23 of said Oak Knoll Subd.; thence S 28°14' E 76.49 feet; thence S 73°07' W 18.02 feet; thence N 14°37' W 75.05 feet to the place of beginning.

Surveyed for: **Charles Weber**
N7330 Krahn Drive
Whitewater, Wisconsin. 53190

Water elevation is 872.4
as measured September 10, 2008

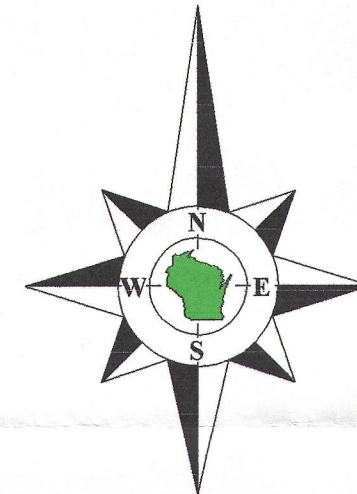

Bearings reference to the meander line of Whitewater Lake, recorded as S29°47'E on the plat of Oak Knoll.

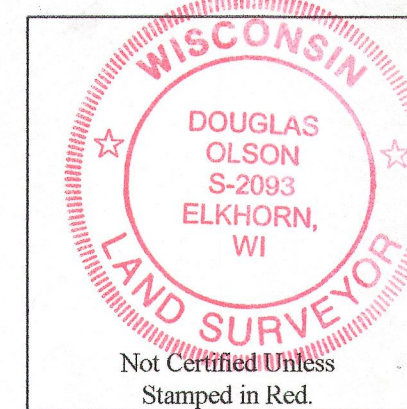

Notes:

- 1) This survey plat is not certified unless signed and sealed in red ink.
- 2) This survey is subject to Wisconsin lien laws. This Plat of Survey is the notice of intent to file lien. Lien waiver required.

Copyright 2008 by Jensen & Olson Land Surveying, LLC.

All rights reserved. No part of this survey plat may be reproduced or transmitted in any form by any means - graphic, electronic, or mechanical, including photocopying, tracing, or information storage and retrieval systems - without permission in writing from Douglas G. Olson, Jensen & Olson Land Surveying, LLC.

I, Douglas G. Olson, Wisconsin Registered Land Surveyor, do hereby certify that this survey was performed by me, or under my direction in full compliance with the owner's/agent's instructions and Chapter A-E 7 of the Wisconsin Administrative Code "Minimum Standards for Property Surveys", and that this map is an accurate representation thereof to the best of my knowledge and belief.

Douglas G. Olson
Wisconsin Registered Land Surveyor - 2093

No. 8 - Doc. No. 857807

Survey Date: September 10, 2008.
Revisions: No. 1 - Set Rods
No. 2 - Adjacent Houses & Shoreyard Setback
No. 3 - Adjacent Houses & Shoreyard Setback
No. 4 - Parcel A
No. 5 - Proposed House, Garage & Stoop
No. 7 - Proposed House

Scale in Feet
1" = 20'
0' 10' 20' 40'

Jensen & Olson Land Surveying, LLC
45 South Wisconsin Street * P.O. Box 322 * Elkhorn, Wisconsin. 53121
Telephone: (262) 723-3434 * Facsimile: (262) 723-8044
Email: jensen.olson@elknet.net

Legend
Found Iron Pipe ☒ Set Iron Rod
Recorded Information
Concrete Cover ☐ Septic Vent
Utility Pole ☐ Pedestal
Deciduous Tree & Diameter
Asphalt Surface ☐ Concrete
Patio Blocks ☐ Set Lath

Sheet 1 of 1 Sheets
Job Reference Number
2013.005

2013.005

DOK 00006 415-1279