



# Plat of Survey

of

Lots 7 and 9 of Ralph and Clara Aldridge Subdivision,

Located in the Northeast 1/4 of Section 35, Town 4 North, Range 15 East, Town of Whitewater, Walworth County, Wisconsin.

Surveyed for: **Marie L. Wrazel**  
W7760 Hackett Road  
Whitewater, Wisconsin. 53190

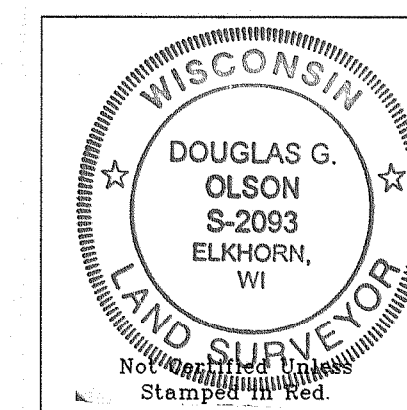
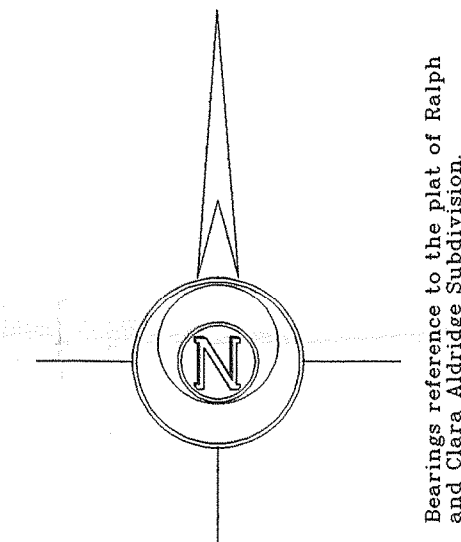

- Notes: 1) This survey plat is not certified unless signed and sealed in red ink.
- 2) This survey is subject to Wisconsin lien laws. This Plat of Survey is the notice of intent to file lien. Lien waiver required.

Copyright © 2006 by Jensen & Olson Land Surveying, LLC.

All rights reserved. No part of this survey plat may be reproduced or transmitted in any form by any means - graphic, electronic, or mechanical, including photocopying, tracing, or information storage and retrieval systems - without permission in writing from Douglas G. Olson, Jensen & Olson Land Surveying, LLC.

I, Douglas G. Olson, Wisconsin Registered Land Surveyor, do hereby certify that this survey was performed by me or under my direction in full compliance with the owners/agent's instructions and Chapter A-E 7 of the Wisconsin Administrative Code "Minimum Standards for Property Surveys", and that this map is an accurate representation thereof to the best of my knowledge and belief.

Douglas G. Olson  
Wisconsin Registered Land Surveyor - 2093

Survey date: April 14, 2006  
Revisions: No. 1 - Lath set on line  
No. 2 - Sheds

Scale in Feet  
1" = 30'  
0' 15' 30' 60' 90'

Jensen & Olson Land Surveying, LLC  
45 South Wisconsin Street P.O. Box 322  
Elkhorn, Wisconsin. 53121  
Telephone: (262) 723-3434  
Facsimile: (262) 723-8044

- Legend**
- Found Iron Pipe 1 1/2" dia
  - Found Iron Rod 3/4" dia
  - Set Iron Rod 3/4" dia
  - Set Wood Lath 1 1/2" dia
  - Utility Pole
  - Information
  - Concrete Surface
  - Asphalt Surface
  - Gravel Surface
  - Grass
  - Water
  - Shed
  - Garage
  - House
  - Well
  - Dog Pen
  - Overhead Wires
  - Fence 0.5' W. of line
  - Fence 0.4' W. of line
  - Fence 0.3' W. of line
  - Fence 0.2' W. of line
  - Fence 0.1' W. of line
  - Fence 0.0' W. of line
  - 10' Wide Utility Easement
  - As shown on the plat of Ralph and Clara Aldridge Subdivision

Sheet 1 of 1 Sheets.

Job Reference Number

2006.040

2006.040

DBA-7 DBA-9

415-1172