

Plat of Survey

of

Lots 7, 8 and 9 of Ralph and Clara Aldridge Subdivision,

Located in the Northeast 1/4 of Section 35, Town 4 North, Range 15 East, Town of Whitewater, Walworth County, Wisconsin.

Surveyed for: Marie L. Wrazel
W7760 Hackett Road
Whitewater, Wisconsin. 53190

Survey date: April 14, 2006
Revisions: No. 1 - Lath set on line.

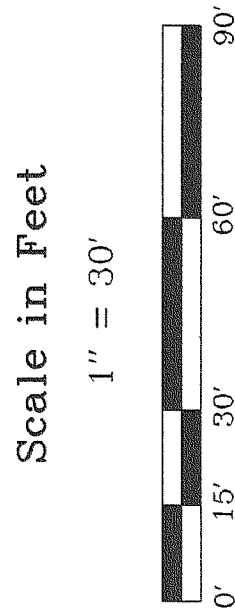

Jensen & Olson Land Surveying, LLC

45 South Wisconsin Street P.O. Box 322
Elkhorn, Wisconsin. 53121
Telephone: (262) 723-3434
Facsimile: (262) 723-8044



Legend

- Found Iron Rod, 1-3/4" dia.
- Found Iron Rod, 3/4" dia.
- Recorded Information
- Utility Pole
- Concrete Cover
- Septic Vent
- Concrete Surface
- Set Wood Lath
- 06-05-06

Sheet 1 of 1 Sheets.

Job Reference Number
2006.040

2006.040

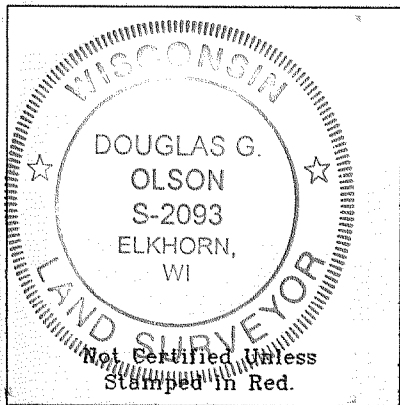
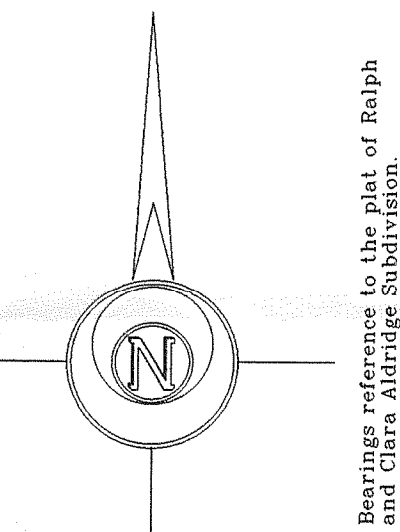

Notes: 1) This survey plat is not certified unless signed and sealed in red ink.
2) This survey is subject to Wisconsin lien laws. This Plat of Survey is the notice of intent to file lien. Lien waiver required.

Copyright © 2006 by Jensen & Olson Land Surveying, LLC.

All rights reserved. No part of this survey plat may be reproduced or transmitted in any form by any means - graphic, electronic, or mechanical, including photocopying, tracing, or information storage and retrieval systems - without permission in writing from Douglas G. Olson, Jensen & Olson Land Surveying, LLC.

I, Douglas G. Olson, Wisconsin Registered Land Surveyor, do hereby certify that this survey was performed by me or under my direction in full compliance with the owner's/agent's instructions and Chapter A-E 7 of the Wisconsin Administrative Code "Minimum Standards for Property Surveys", and that this map is an accurate representation thereof to the best of my knowledge and belief.

Douglas G. Olson
Wisconsin Registered Land Surveyor - 2093



DBA-7 DBA-8 DBA-9

4/5-1170