

LAND-MARK SURVEYING

Mark L. Miritz

Wisconsin Registered Land Surveyor S-2582

N9330 Knuteson Drive

Whitewater, WI 53190

Phone: (262) 495-3284

FAX: (262) 495-8421

LAND-MARKSURVEYING.COM

PLAT OF SURVEY

LOT 2 OF CERTIFIED SURVEY MAP NO. 1783, LOCATED IN THE SW 1/4 AND THE NW 1/4 OF THE NW 1/4 OF SECTION 6, TOWN 4 NORTH, RANGE 15 EAST, WHITEWATER TOWNSHIP, WALWORTH COUNTY, WISCONSIN.

OWNERS: KEITH J. JASS
LINDA NORTON
613 RICKORDS ST.
DELAVAN, WI 53115

NOTES:

- 1) WOOD STAKES HAVE BEEN PLACED AT THE BUILDING CORNERS WITH 10' OFFSETS AS MARKED, BUILDER IS TO VERIFY DIMENSIONS TO INSURE PROPER PLAN INTERPRETATION AND CONTACT THIS OFFICE IMMEDIATELY IF ANY DISCREPANCY EXISTS.
- 2) FOUNDATION DIMENSIONS WERE REDUCED AS PER MFG. SPECIFICATIONS TO ACCOMMODATE 1" INSULATION

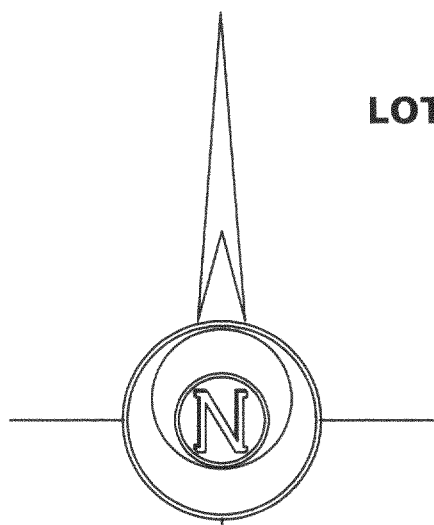

PLATTED NORTH

LOT 1

LOT 2

52,714 SQ. FT.

HOMBURG

LANE

LOT 3

LEGEND

- FOUND IRON PIPE
- FOUND IRON ROD
- FOUND COUNTY MONUMENT
- WOOD STAKE AT 10' OFFSET
- CHISEL CUT IN CONCRETE
- SET IRON ROD, 24" LONG, WEIGHING 1.5 LBS./LINEAL FT., 3/4" DIA.
- (x x) RECORDED AS DIMENSION
- EXISTING FENCE

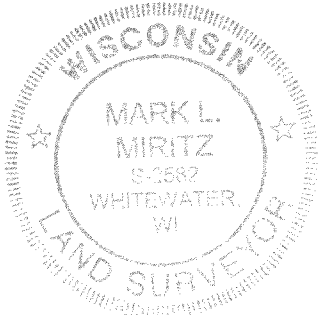

SCALE: 1" = 40 FEET

"I hereby certify that the above described property has been surveyed by me or under my direction and that the above map is a true representation thereof and shows the size and location of the property, its exterior boundaries, the location of all visible structures and dimensions of all principal buildings thereon, boundary fences, apparent easements, roadways and visible encroachments, if any."
"This survey is made for the use of the present owners of the property, and also those who purchase, mortgage, or guarantee the title thereto within one year from date hereof."

Mark L. Miritz
MARK L. MIRITZ
WISCONSIN REGISTERED
LAND SURVEYOR S-2582

REVISED JAN. 29, 2006 TO SHOW PROPOSED DECK & SHED

DATE: JANUARY 23, 2006 JOB NO. 06.111

DA 1783-2

415-1059