

Plat of Survey

of

Lot 1 of Certified Survey Map No. 2774,

recorded in Vol. 14 of Certified Survey Maps of Walworth County on
Page 170 and located in the Southwest 1/4 of Section 10, Town 3
North, Range 18 East, Town of Spring Prairie, Walworth County, Wisconsin.

Surveyed for: **Terry Wilson**
N6500 Church Road
Burlington, Wisconsin. 53105

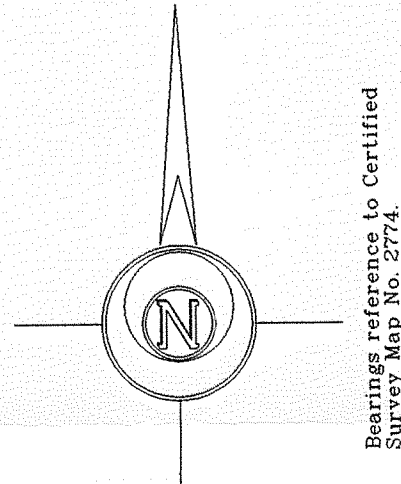

Tax Parcel
OSP 1000004B

Copyright © 2006 by Jensen & Olson Land Surveying, LLC.

All rights reserved. No part of this survey plat may be reproduced or transmitted in any form by any means - graphic, electronic, or mechanical, including photocopying, tracing, or information storage and retrieval systems - without permission in writing from Douglas G. Olson, Jensen & Olson Land Surveying, LLC.

I, Douglas G. Olson, Wisconsin Registered Land Surveyor, do hereby certify that this survey was performed by me or under my direction in full compliance with the owner's/agent's instructions and Chapter A-E 7 of the Wisconsin Administrative Code "Minimum Standards for Property Surveys", and that this map is an accurate representation thereof to the best of my knowledge and belief.

Douglas G. Olson
Wisconsin Registered Land Surveyor - 2093

South line of the Southeast 1/4 of the Southwest 1/4 of Section 10-3-16.

Concrete Monument North 1/8 corner of the Northwest 1/4 of Section 15-3-18 as shown on county tie sheets
Found pipe set by Robert Wetzel for Northeast corner of C.S.M. 2728 1.09' N85°55'04"W of concrete monument at corner.

S88°57'16"E 785.00'

S88°57'16"E 1315.61'

Tax Parcel
OSP 1500002

N88°57'16"W 179.78'
(N88°57'16"W 180.00')

Found pipe
is 0.13' N. of
Section line

South 1/4 Corner
Section 10-3-18.
(N. 269.357.87)
(E. 2,441,688.61)

Notes: 1) This survey plat is not certified unless signed and sealed in red ink.

2) This survey is subject to Wisconsin lien laws. This Plat of Survey is the notice of intent to file lien. Lien waiver required.

Tax Parcel
OSP 1000004B

(S79°57'44"E 511.04')
S79°58'34"E 511.06'

S20°18'55"W 318.10'
(S20°19'44"W 318.00')

S26°32'33"W 421.13'
(S26°32'44"W 421.00')

Tax Parcel
OSP 1000004B

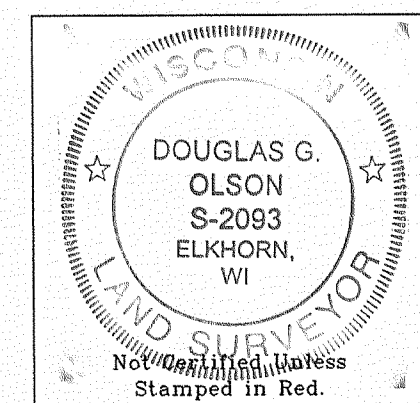
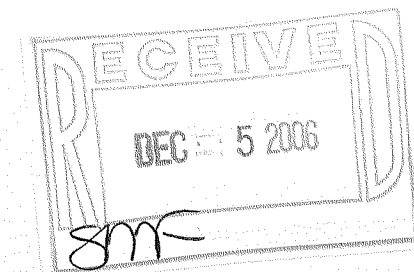

Shed
16.0' x 20.0'

House
N6500

Well

(N1°51'16"W 761.00')
N1°52'24"W 761.14'

478.14'

Lot 1
5.940 Acres
258,472 Sq.Ft.

Survey Date: July 25, 2006.
Revisions: No. 1 - New shed location

Scale in Feet
1" = 50'
0' 25' 50' 100'

Jensen & Olson Land Surveying, LLC
45 South Wisconsin Street
Elkhorn, Wisconsin. 53121
Telephone (262) 723-3434
Facsimile (262) 723-8044

Legend
☒ Found County Section Corner
☒ Found Iron Pipe ☐ Set Wood
☒ Set Iron Rod, 3/4" dia. Stake
() Recorded Information
☒ Concrete Cover ☒ PVC Pipe
☒ Utility Box ☒ Flag by others
☒ Gravel Surface ☒ Brick

Sheet 1 of 1 Sheets
Job Reference Number
2006.088
2006.088

0A2774-1

318-991