

LEGAL DESCRIPTION

LOT #2 OF CSM # \_\_\_\_\_, BEING A PART OF THE NORTHEAST 1/4 AND SOUTHEAST 1/4 OF THE NORTHEAST 1/4 OF SECTION 2, TOWNSHIP 3 NORTH, RANGE 18 EAST, TOWN OF SPRING PRAIRIE, WALWORTH COUNTY, WISCONSIN.

CSM #2538

S 88°25'23"W 485.82'

LOT #2, CSM # \_\_\_\_\_

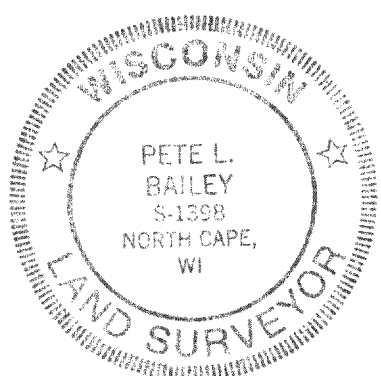

NOTE: SUGGESTED YARD GRADE MUST BE APPROVED BY THE OWNER AND MUNICIPALITY.

VACANT

N 30°29'32"E 179.35'

SCALE

0 40 80

FEET



NORTH

REGRADE AS NECESSARY TO INSURE PROPER DRAINAGE AWAY FROM GARAGE & HOUSE

DENOTES PROPOSED STAKED EROSION CONTROL

DENOTES PROPOSED SPOIL STOCKPILE

EXISTING GRAVE/DIRT DRIVEWAY. SLOPE VARIES.

SITE BENCHMARK - SPIKE IN LARGE OAK TREE PER SOIL & SITE EVALUATION REPORT. ELEVATION - 100.00.

VACANT

VACANT

LOT #3, CSM # \_\_\_\_\_

VACANT

STATE OF WISCONSIN  
COUNTY OF RACINE

The above-described property has been surveyed under my direction and the above map is a correct representation thereof.

DATED AT: NORTH CAPE, THIS 30TH DAY OF AUGUST, 1999.

*P. L. Bailey*  
AMERICAN SURVEYING COMPANY, INC.  
PETE L. BAILEY, RLS NO. 1398  
RECERTIFIED this \_\_\_\_\_ day of \_\_\_\_\_, 1999.

NOTE:

- PROPOSED HOUSE STAKED ON LINE.
- ELEVATIONS BASED ON MUNICIPAL DATUM.
- SUGGESTED YARD GRADE 122.50
- SUGGESTED GARAGE SLAB: 122.83
- - DENOTES IRON PIPE FOUND
- - DENOTES IRON ROD SET

LOT AREA: 217,802 S.F.

LOT #1, CSM # \_\_\_\_\_

TO CTH "D"

66' INGRESS/EGRESS AND UTILITY EASEMENT

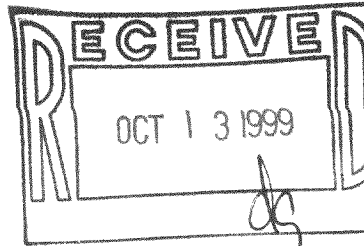

TOWN OF SPRING PRAIRIE

PROJECT:

STAKEOUT/PLAT OF SURVEY

PREPARED FOR: NORM KEEKER  
OWNER: AL & SHARIE HANSEN

Sheet

1 of 1

AMERICAN SURVEYING COMPANY, INC.

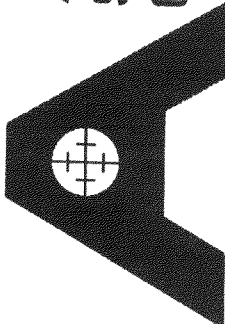

12207 C.T.H. "K" FRANKSVILLE, WISCONSIN 53126  
TEL. (414) 835-4774 FAX: (414) 835-2379

DRAWN BY: ALJ REVISIONS: DATE

CHECKED BY: ALJ

PLOT SCALE: 1" = 40'

DATE: 08/30/99

JOB NO.: 99226

DWG. FILE: JN99233