

DEGEN, FOAT SURVEYING ASSOCIATES

100 SOUTH SECOND STREET
WATERFORD, WISCONSIN
(414)534-5404 (FAX)534-2022

982275
982275S1.DWG

PLAT OF SURVEY

LOT 3, CERTIFIED SURVEY MAP NO. 2962 ACCORDING TO THE RECORDED PLAT THEREOF
RECORDED IN VOLUME 15 OF CERTIFIED SURVEY MAPS ON PAGE 270 AS DOCUMENT NO. 377484,
BEING PART OF THE NORTHEAST 1/4 AND THE SOUTHEAST 1/4 OF THE SOUTHEAST 1/4
OF SECTION 3, TOWN 3 NORTH, RANGE 18 EAST OF THE FOURTH PRINCIPAL MERIDIAN,
TOWN OF SPRING PRAIRIE, WALWORTH COUNTY, WISCONSIN. TOGETHER WITH A 66' WIDE EASEMENT
FOR INGRESS AND EGRESS AS SHOWN ON SAID CERTIFIED SURVEY MAP NO. 2962.

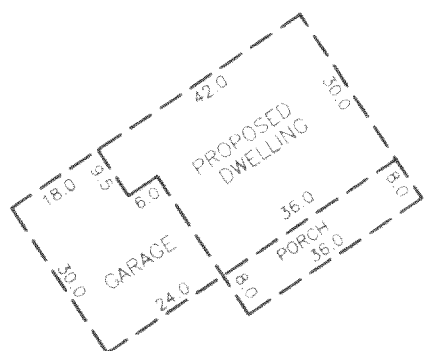

N 87°30'00" W - 300.50

LOT 3

Area = 267019 sq.ft
6.1299 Acres

LOT 2

LOT 4

SOUTH - 928.39

NORTH - 850.47

SCALE: 1" = 100'

BEARING BASE: THE EAST LINE OF THE SOUTHEAST 1/4
OF SECTION 3-3-18, WHICH WAS ASSUMED AS NORTH.

LEGEND

- + - CROSS CUT IN CONCRETE
- o - PK NAIL
- ⊙ - FOUND IRON PIPE
- - FOUND IRON ROD
- - SET IRON PIPE
- - FENCE
- () - RECORDED AS
- ◆ - SOIL BORING
- ⊕ - BENCH MARK
- ⊗ - FOUND CONCRETE MONUMENT

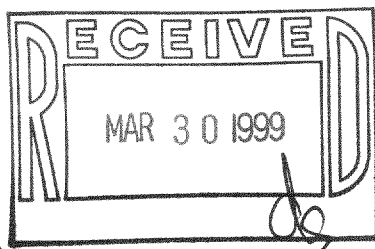

SURVEYED FOR: BECKY WEBER & RANDALL LARUE
1101 NEW STREET
UNION GROVE, WI 53182

I HEREBY CERTIFY THAT I HAVE SURVEYED THE ABOVE DESCRIBED PROPERTY AND THE ABOVE MAP IS A TRUE REPRESENTATION THEREOF
AND SHOWS THE SIZE AND LOCATION OF THE PROPERTY, THE LOCATION OF ALL VISIBLE STRUCTURES AND DIMENSIONS OF ALL PRINCIPAL
BUILDINGS THEREON, BOUNDARY FENCES, APPARENT EASEMENTS, ROADWAY AND VISIBLE ENCROACHMENTS, IF ANY.

THIS SURVEY IS MADE FOR THE PRESENT OWNERS OF THE PROPERTY, AND ALSO THOSE WHO PURCHASE, OR GUARANTEE THE TITLE THERETO
WITHIN (1) YEAR FROM THE DATE HEREOF

DATED AT WATERFORD THIS 28TH DAY OF JULY 1998

RECORDED

0A-2962-3
318-650