

of

recorded January 18, 2024 as Document Number 1089665 and located in the Northwest 1/4, Northeast 1/4, Southwest 1/4 and Southeast 1/4 of the Southwest 1/4 and the Northwest 1/4 of the Southeast 1/4, all in Section 16, Town 3 North, Range 18 East, Town of Spring Prairie, Walworth County, Wisconsin.

Tax Parcel
OSP 1600008

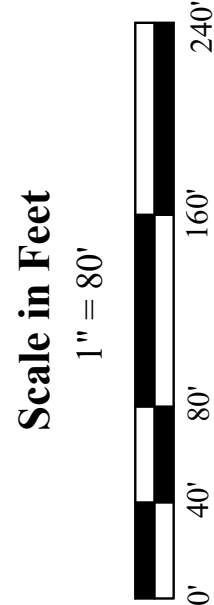

45 South Wisconsin Street | P.O. Box 322
Elkhorn, Wisconsin. 53121
Telephone: (262) 723-3434
Facsimile: (262) 723-8044
Email: doug@olsonsurveying.com
Website: www.olsonsurveying.com



Legend

Found County Section Corner
Found iron pipe
Found iron rod
Set iron Pipe, 1" dia. Set Wood Lath
Set iron Pipe, 1" dia. Recorded Information
Utility Pole
Utility Pedestal
Septic Tank
Asphalt Surface
Concrete Surface
Gravel Surface

N North
E East
W West
S South
Degrees
Minutes
Seconds
In Distances
Feet
No Number
NW Northwest
NE Northeast
SE Southeast
SW Southwest

Sheet 1 of 1 Sheets

Name:

Job Reference Number

2022.017

2022.017

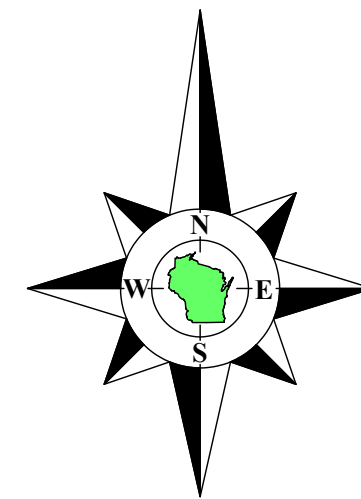

Bearings referenced to the West line of the Southwest 1/4 of Section 16-3-18, recorded as N2°01'21"W in the Wisconsin State Plane Coordinate System, South Zone, (NAD-27).

Coordinates are referenced to the Wisconsin State Plane Coordinate System, South Zone, (NAD-27)

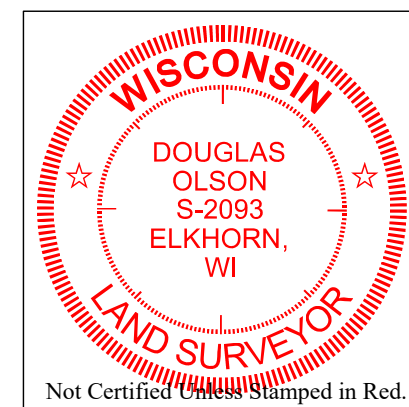

Notes:

- 1) This Plat of Survey is not certified unless signed and sealed in red ink.
- 2) This survey is subject to Wisconsin lien laws. This Plat of Survey is the notice of intent to file lien. Lien waiver required.
- 3) The Survey Date shown on this Plat of Survey is the completion date of the field work.

Copyright © 2024 by Olson Land Surveying, LLC.

All rights reserved. No part of this survey plat may be reproduced or transmitted in any form by any means - graphic, electronic, or mechanical, including photocopying, tracing, or information storage and retrieval systems - without permission in writing from Douglas G. Olson, Olson Land Surveying, LLC.

I hereby certify that I have surveyed the above described property in compliance with Chapter A-E 7 of the Wisconsin Administrative Code and that the map hereon is correct to the best of my professional knowledge and belief and shows the size and location of the property, its exterior boundaries, the location and dimensions of all visible structures thereon, boundary fences, apparent easements and roadways and visible encroachments, if any.

This survey is made for the exclusive use of the present owners of the property, and also those who purchase, mortgage or guarantee title thereto, within one year from the date hereof.

Douglas G. Olson
Wisconsin Professional Land Surveyor - 2093

Tax Parcel
OSP 1600005

Lot 2
Tax Parcel
OA513700002
5.017 Acres
218,541 Sq.Ft.

Lot 1
Tax Parcel
OA513700001
5.050 Acres
219,974 Sq.Ft.

Plot 4
Parcel
700004
Acres
8 Sq.Ft.

Lot 3
Tax Parcel
OA513700003
8.633 Acres
376,035 Sq.Ft.

Tax Parcel
OSP 1600005

"Drainage System" And
"Tile System" Easement
Doc. No. 1080750
Exact location unknown

Note from C.S.M. 5137
Access for Lot 1 onto Potter Road must be located within the Ingress & Egress Easement for Lot 3.

Note from C.S.M. 5137
The 50' Wide Ingress, Egress & Utility Easements shown intersect the right of way lines of Potter Road at an angle. When the driveways are built they shall intersect the pavement in a perpendicular manner.

Portion of 50' Wide Ingress
& Utility Easement For
As Shown on C.S.M. 5137 b
of C.S.M. 5137
Doc. No. 1090749

Tax Parcel
OSP 1600005

Lot 1
C.S.M. 2227

Description of Access Easement on Lot 4

An Access Easement located on a portion of Lot 4 of Certified Survey Map No. 5137, recorded January 18, 2024 as Document Number 1089665 and located in the Northwest 1/4 and Northeast 1/4 of the Southwest 1/4 of Section 16, Town 3 North, Range 18 East, Town of Spring Prairie, Walworth County, Wisconsin, described as follows: Commence at the Southwest corner of said Section 16; thence North 2°01'30" East, along a Westerly line of said Section 16, 120.00 feet; thence North 87°53'38" East, 98.00 feet to an iron pipe at a corner of Lot 3 of Certified Survey Map No. 5137; thence North 14°51'40" West, along a Westerly line of said Lot 3, 209.91 feet to an iron pipe; thence North 58°23'33" East, along a Northerly line of said Lot 3, 427.99 feet to an iron pipe; thence North 5°32'00" West, along a Westerly line of said Lots 3 and 4, 597.05 feet to the Point of Beginning; thence North 5°32'00" West, along a Westerly line of said Lot 4, 20.05 feet to an iron pipe; thence North 80°36'08" East, along a Northerly line of said Lot 4, 120.00 feet; thence South 20°24'55" West, 23.05 feet; thence South 80°36'08" West, 110.00 feet to the Point of Beginning.

Tax Parcel
OSP 1600005

West 1/4 Corner
Section 16-3-18
N. 266,618.99
E. 2,433,829.65

Southwest Corner
Section 16-3-18
N. 263,986.99