

West 1/4 Corner
Section 18-3-18
(N. 288,459.19)
(E. 2,423,551.71)

Plat of Survey

of

Lot 2 of Certified Survey Map No. 1940,

recorded in Vol. 9 of Certified Survey Maps of Walworth County on Page 164 and located in the Southwest 1/4 of Section 18, Town 3 North, Range 18 East, Town of Spring Prairie, Walworth County, Wisconsin.

Surveyed for: **Richard Fleming**
24504 85th Place
Salem, Wisconsin. 53168

Tax Parcel
OSP 1800004



Bearings reference to Certified Survey Map No. 1940.

Town Line Road
(66' Wide)

(N1°10'17"W 338.34')
N1°10'17"W 338.35'

(N2°20'33"W 2628.87')
N1°10'17"W 2628.87'
West line of the Southwest 1/4 of Section 18-3-18.
(S77°04' 877.84')
(S78°00')

Southwest Corner
Section 18-3-18
(N. 263,832.82)
(E. 2,423,363.81)

(N89°55'30"E 644.52')
N89°54'06"E 646.36'

N89°54'06"E 330'
(330')
Perpetual Driveway Easement
As shown on Certified Survey Map No. 1940.

Lot 2
Tax Parcel
OA194000002

5.016 Acres
218,482 Sq.Ft.
4.759 Acres
207,316 Sq.Ft.
Exclusive of R.O.W.

(S89°57'55"W 643.98')
S89°57'55"W 643.98'
(S89°55'30"E 643.18')

Lot 3
C.S.M. 1940

Lot 1
C.S.M. 1940

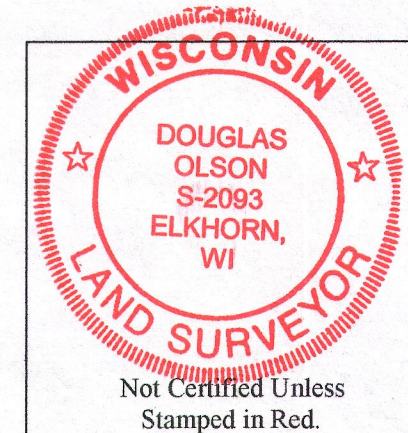

- Notes:
- 1) This survey plat is not certified unless signed and sealed in red ink.
 - 2) This survey is subject to Wisconsin lien laws. This Plat of Survey is the notice of intent to file lien. Lien waiver required.

Copyright © 2015 by Olson Land Surveying, LLC.

All rights reserved. No part of this survey plat may be reproduced or transmitted in any form by any means - graphic, electronic, or mechanical, including photocopying, tracing, or information storage and retrieval systems - without permission in writing from Douglas G. Olson, Olson Land Surveying, LLC.

I, Douglas G. Olson, Wisconsin Professional Land Surveyor, do hereby certify that this survey was performed by me, or under my direction in full compliance with the owner's/agent's instructions and Chapter A-E 7 of the Wisconsin Administrative Code "Minimum Standards for Property Surveys", and that this map is an accurate representation thereof to the best of my knowledge and belief.

Douglas G. Olson
Wisconsin Professional Land Surveyor - 2093

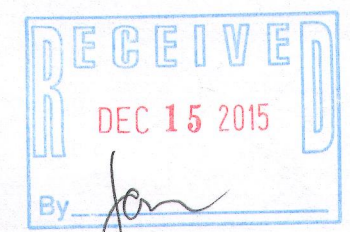

Survey date: November 13, 2015.
REVISIONS:

Scale in Feet
1" = 30'

Olson Land Surveying, LLC
45 South Wisconsin Street * P.O. Box 322 * Elkhorn, Wisconsin. 53121
Telephone: (262) 723-3434 * Facsimile: (262) 723-8044

Legend
Found County Section Corner
Found Iron Rod
Found Iron Rod, 3/4" dia.
Recorded Information
Utility Easement
Utility Easement

Sheet 1 of 1 Sheets
Job Reference Number