

May 5, 2006

PLAT OF SURVEY

Survey No. 060127R
Quality Crafted Homes, Inc.

LOCATION: _____ Bowers Road, Lafayette, Wisconsin

LEGAL DESCRIPTION:

Lot 2 of **CERTIFIED SURVEY MAP NO. 3881**, Being a part of the Northwest 1/4 of the Southwest 1/4 of the Southwest 1/4 of Section 12, Township 3 North, Range 17 East of the Fourth Principal Meridian, in the Town of LaFayette, Walworth County, Wisconsin.

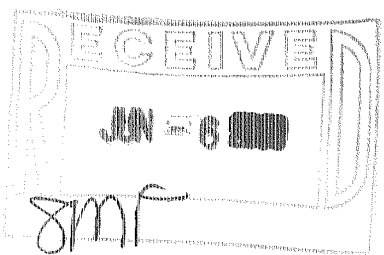
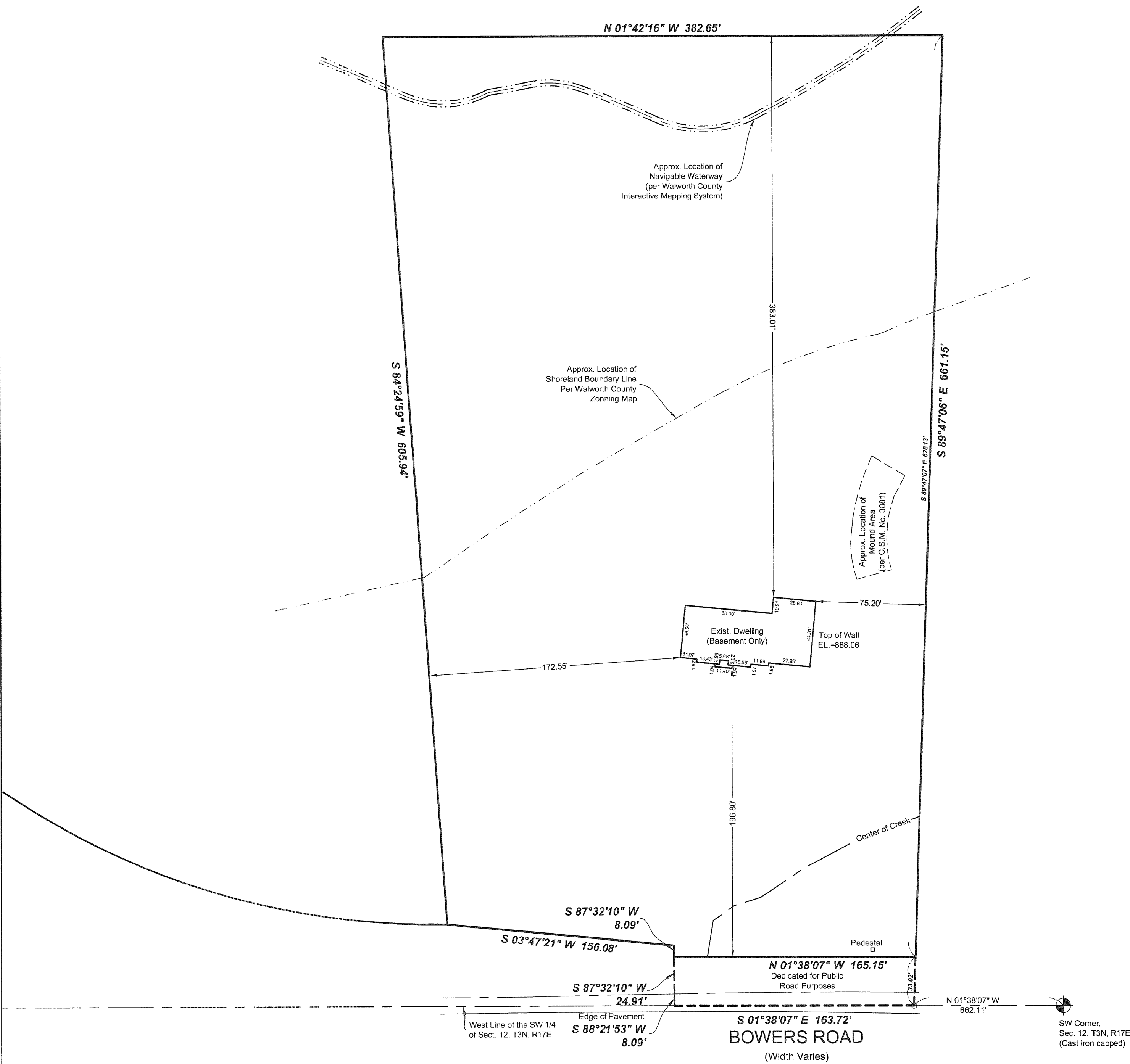
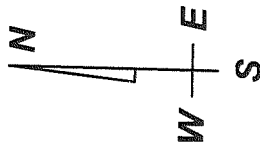

Mortgage Inspection
Monumentation has been waived in accordance with A-5 5.01 (b) of the Wisconsin Administrative Code.

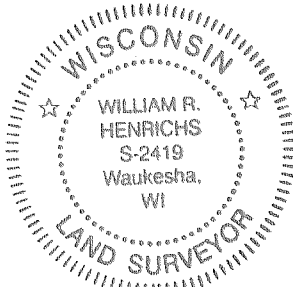

DRAWING BY: AW
FIELD WORK BY: JP

LANDCRAFT SURVEY AND ENGINEERING, INC.
REGISTERED LAND SURVEYORS AND CIVIL ENGINEERS
2077 South 116th Street, West Allis, WI 53227
PH. (414) 604-0674 FAX (414) 604-0677
INFO@LANDCRAFTSE.COM

I HEREBY CERTIFY THAT I HAVE SURVEYED THE ABOVE DESCRIBED PROPERTY AND THAT THE ABOVE MAP IS A TRUE REPRESENTATION THEREOF AND SHOWS THE SIZE AND LOCATION OF THE PROPERTY. ITS EXTERIOR BOUNDARIES, THE LOCATION OF ALL VISIBLE STRUCTURES AND DIMENSIONS OF ALL PRINCIPAL BUILDINGS THEREON, BOUNDARY FENCES, APPARENT EASEMENTS AND ROADWAYS AND VISIBLE ENCROACHMENT, IF ANY.

THIS SURVEY IS MADE FOR THE EXCLUSIVE USE OF THE PRESENT OWNERS OF THE PROPERTY, AND ALSO THOSE WHO PURCHASE, MORTGAGE, OR GUARANTEE THE TITLE THERETO WITHIN ONE (1) YEAR FROM THE DATE HEREOF.

SIGNED *William R. Henrichs*
William R. Henrichs, Registered Land Surveyor S-2419

KA3881-2

317-853