

Plat of Survey

Tax Parcel KLF 2800006,

A parcel of land described in a Quit Claim Deed recorded in Vol. 649 on Page 3070 as Document No. 362657, as shown below:
THAT PART OF THE W 1/2 - NW 1/4 OF SECTION 28, TOWNSHIP 3 NORTH, RANGE 17 EAST, DESCRIBED AS FOLLOWS: BEGIN IN THE EAST LINE OF THE W 1/2 OF SAID NW 1/4 AT A POINT 1320.43 NORTH 89°36'16" EAST AND 110 FEET NORTH 0°23'44" WEST OF THE SOUTHWEST CORNER OF SAID NW 1/4 AS MEASURED ALONG AND NORMAL TO THE SOUTH LINE OF SAID NW 1/4; THENCE SOUTH 89°36'16" WEST 924.37 FEET; THENCE NORTH 34°44'20" EAST 1149.82 FEET; THENCE NORTH 39°45'55" EAST 344.00 FEET TO THE EAST LINE OF THE W 1/2 OF SAID NW 1/4; THENCE SOUTH 2°20'15" EAST TO THE POINT OF BEGINNING, CONTAINING 13.16 ACRES, MORE OR LESS.

Surveyed for: Kevin Robers
W4484 Potter Road
Elkhorn, Wisconsin. 53121

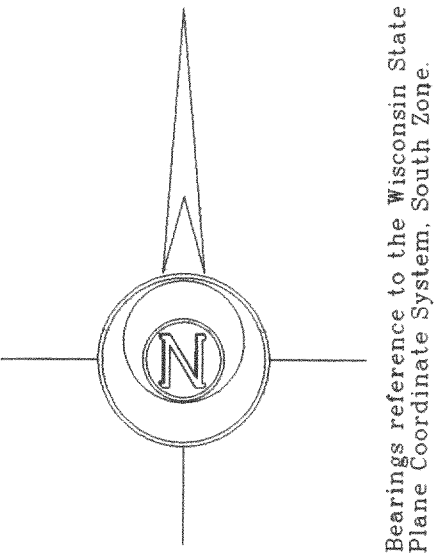

Interstate Highway 43

Tax Parcel
KLF 2800006

13.165 Acres
573,447 Sq.Ft.

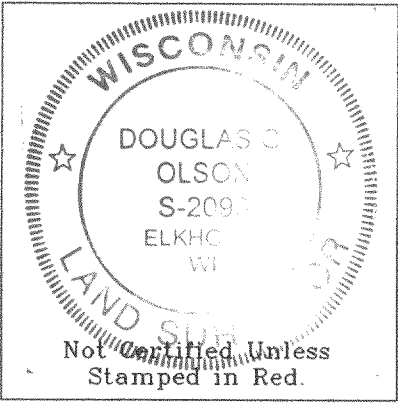

Notes: 1) This survey plat is not certified unless signed and sealed in red ink.
2) This survey is subject to Wisconsin lien laws. This Plat of Survey is the notice of intent to file lien. Lien waiver required.

Tax Parcel
KLF 2800004

State Trunk Highway 11

Newman Drive

I, Douglas G. Olson, Wisconsin Registered Land Surveyor, do hereby certify that this survey was performed by me or under my direction in full compliance with the owner's/agent's instructions and Chapter A-E 7 of the Wisconsin Administrative Code "Minimum Standards for Property Surveys" and that this map is an accurate representation thereof to the best of my knowledge and belief.

Douglas G. Olson
Wisconsin Registered Land Surveyor - 2093

Sheet 1 of 1 Sheets.

Job Reference Number
2002.090

Legend

- Found County Section Corner
- Set Iron Rod, 3/4" dia
- Recorded Information
- Utility Pole
- Concrete Cover
- PVC Pipe
- Asphalt Surface
- Gravel Surface
- Access Restriction



Jensen & Olson Land Surveying, LLC

45 South Wisconsin Street P.O. Box 322
Elkhorn, Wisconsin. 53121
Telephone: (262) 723-3434
Facsimile: (262) 723-8044

Scale in Feet

1" = 60'



Survey date: August 25, 2005.
Revisions:

MAY 11 2005
smk

KLF 2846

317-844