

PREPARED FOR : JON WITTRICK  
419 W. PARK DR.  
TWIN LAKES WI. 53181

# PLAT OF SURVEY

J.K. SURVEYING INC.  
N3705 WILLOWBEND LANE  
LAKE GENEVA, WI, 53147  
262-248-3697

-OF-

UNIT 54 OF ROLLING GREEN COUNTRY ESTATES CONDOMINIUM,  
A CONDOMINIUM LOCATED IN THE SOUTHEAST 1/4 AND THE  
SOUTHWEST 1/4 OF SECTION 18, T3N, R17E, TOWN OF LAFAYETTE,  
WALWORTH COUNTY, WISCONSIN.

UNIT 54

UNIT 53

HOUSE UNDER  
CONSTRUCTION

UNIT 55

C.L. PEBBLE DRIVE  
(66' WIDE)

( ) = recorded as

□ = found iron bar

● = found iron pipe

● = set iron pipe

■ = set iron bar

SCALE 1" = 30'

JOB # 03-316AB

TAX ID # KRG 00054

COMPARE LEGAL DESCRIPTION ABOVE AND DRAWING WITH DEED. FOR BUILDING RESTRICTIONS AND  
EASEMENTS NOT SHOWN, REFER TO DEED, ABSTRACT SOURCES AND LOCAL MUNICIPAL CODES. NOTIFY  
THE SURVEYOR IMMEDIATELY OF ANY DISCREPANCY.

"I hereby certify that the above described property was surveyed under my  
supervision and that the above map is a true representation thereof and  
shows the size and location of all visible structures, apparent easements  
and encroachments if any."

This survey is made for the present owners of the property, and those who  
purchase, mortgage, or guarantee the title thereto, within one year from  
the date hereof.

REVISED 08-25-03

DATE OF LAST REVISION 10-22-03

DATED THE 20 TH, DAY OF JUNE 2003

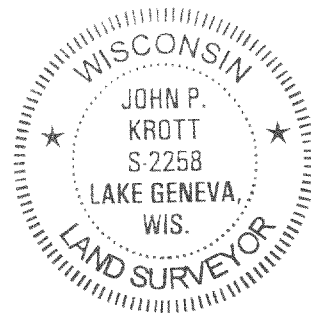

*John P. Krott*  
JOHN KROTT S - 2258  
Wisconsin Registered Land Surveyor  
(original if signed in red)

317-675