

PLAT OF SURVEY

LOT 1 OF C.S.M. 2980
RECORDED IN VOL. 16; PG. 9; DOC. NO. 380774

LOCATED IN ALL 1/4'S OF THE NW 1/4 OF SECTION 18,
TOWN 3 NORTH, RANGE 17 EAST,
WALWORTH COUNTY, WISCONSIN

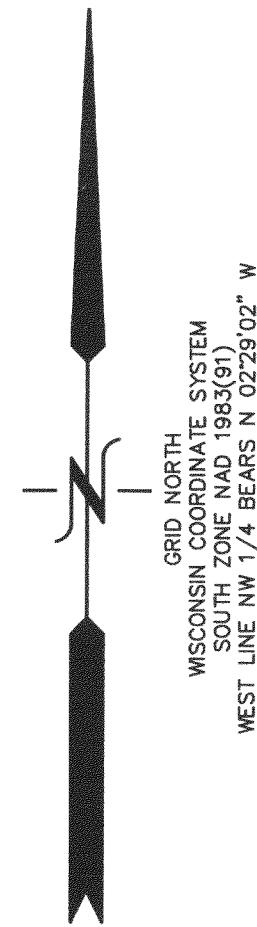

GRID NORTH
WISCONSIN COORDINATE SYSTEM
SOUTH ZONE NAD 1983(91)
WEST LINE NW 1/4 BEARS N 02°29'02" W

UNPLATTED LANDS

UNPLATTED LANDS

(N 02°29'02" W)
151.00'

C.T.H. "ES"
100' WIDE R.O.W.

(NORTHEASTERLY)
N 52°31'39" E
332.04'

(S 02°29'02" E)
231.54'

LOT 1
100,474 S.F.

PROPOSED
RESIDENCE

12.0'

38.5'

45.0'

24.5'

15.0'

72.0'

24.0'

57.6'

514.10
S 87°39'00" W

LOT 2 OF C.S.I. 2980

(N 76°30'20" E)
(N 74°52'36" E)
269.36'
(269.43')

(S 22°10'36" W)
(S 23°34'40" W)
(62.70')
(82.78')

66' WIDE STRIP SHOWN AS A PRIVATE ROAD ON
UNRECORDED SUBDIVISION PLAT TAMARACK RIDGE
NAMED TAMARACK RIDGE ROAD: RIGHTS OF ACCESS
TO SAID EASEMENT VOL. 632; PG. 3406; DOC. NO. 294570

- LEGEND
- = FOUND IRON PIPE STAKE
 - = FOUND IRON REBAR STAKE
 - = POWER POLE
 - (XXX) = RECORDED AS

MAP SCALE IN FEET ORIGINAL 1" = 40'

NOTE: COPIES OF THIS MAP TO WHICH THE FOLLOWING CERTIFICATE WILL APPLY SHOW THE SURVEYOR'S ORIGINAL SEAL AND SIGNATURE IN RED INK. COPIES BY ANY OTHER MEANS MAY HAVE ALTERATIONS WHICH DO NOT REPRESENT THE SURVEYOR'S WORK PRODUCT.

I HEREBY CERTIFY THAT THE ABOVE DESCRIBED PROPERTY HAS BEEN SURVEYED UNDER MY DIRECTION AND THAT THE ABOVE MAP IS A TRUE REPRESENTATION THEREOF AND SHOWS THE SIZE AND LOCATION OF THE PROPERTY AND ITS EXTERIOR BOUNDARIES. THIS SURVEY IS MADE FOR THE USE OF THE PRESENT OWNERS OF THE PROPERTY, AND ALSO THOSE WHO PURCHASE, MORTGAGE, OR GUARANTEE THE TITLE THERETO WITHIN ONE YEAR FROM THE DATE HEREOF.

DATED: 06/13/2003

PETER S. GORDON R.L.S. 2101

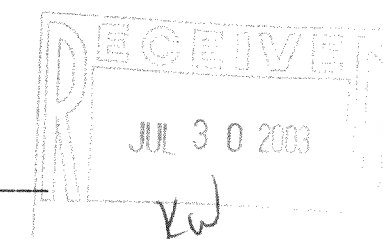

WORK ORDERED BY --
JOE SHIRK
314 NORTH CREEK ROAD
ELKHORN, WI 53121

FARRIS, HANSEN & ASSOCIATES, INC.
ENGINEERING - ARCHITECTURE - SURVEYING
7 RIDGWAY COURT P.O. BOX 437
ELKHORN, WISCONSIN 53121
OFFICE: (262) 723-2098 FAX: (262) 723-5886

REVISIONS
06/20/2003
TO SHOW SIZE
& LOCATION
OF PRO. RES.

PROJECT NO.
4780.01
DATE:
06/13/03
SHEET NO.
1 OF 1