

ABERNATHY and ASSOCIATES

Kenneth B. Abernathy Jr.

Wisconsin Registered Land Surveyor S-1594

Rt. 3, Box 273
Elkhorn, Wisconsin 53121
Phone: (414) 723-4260 (office)
(414) 723-7209 (FAX)

PLAT OF SURVEY

LOT 1, CERTIFIED SURVEY MAP NO. 2345, BEING A RESUBDIVISION OF LOT 15 OF BLOCK 2 OF ALPINE TOWER ESTATES, BEING A SUBDIVISION OF PART OF THE NORTHEAST 1/4 OF SECTION 13, TOWN 3 NORTH, RANGE 17 EAST, TOWN OF LAFAYETTE, WALWORTH COUNTY, WISCONSIN.



I = 66°50'42"
R = 60'
CH = 66.10'
CB = N 54°54'01" E



SCALE: 1" = 30 FEET

ORDERED BY: ROBERT GUNN
W2623 COPPERHEAD LANE
ELKHORN, WIS. 53121

- Legend
- FOUND IRON PIPE
 - FOUND IRON ROD
 - FOUND BRASS-CAPPED MONUMENT
 - ✕ FOUND CONCRETE MONUMENT
 - ✦ CHISEL CUT IN CONCRETE
 - SET IRON ROD, 24" LONG, WEIGHING 1.5 LBS. LINEAL FT., 3/4" DIA.
 - SET IRON ROD, 10" LONG, WEIGHING 4.5 LBS. LINEAL FT., 1 1/16" DIA.
 - (***) RECORDED AS DIMENSION
 - - - - - EXISTING FENCE

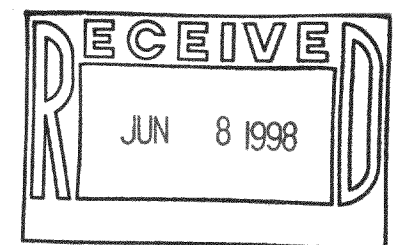

SCALE 1" = 30 FEET

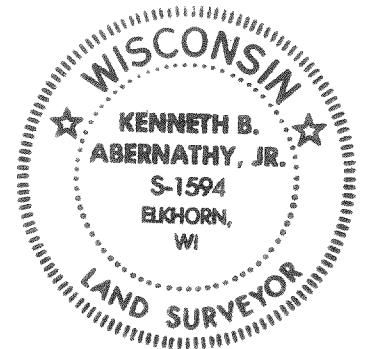

This survey is made for the use of the present owners of the property and also those who purchase, mortgage, or guarantee the title therein within one year from date hereof.

Kenneth B. Abernathy, Jr.

KENNETH B. ABERNATHY, JR.
WISCONSIN REGISTERED LAND SURVEYOR,
S-1594

Date 4-14-98 Job No. 93-80348

317-422
KA-2345-1

DESIGN PRODUCTS