

PLAT OF SURVEY

RECEIVED
ARR 13 PM 2 48

DISPOSITION:

302675

CERTIFIED SURVEY MAP NO. 2578 VOL. 13
PAGES 59 60 & 61

A REPLATTING OF LOT 3 OF CERTIFIED SURVEY MAP NO. 2510 AS RECORDED IN VOL. 12 OF CERTIFIED SURVEY MAPS AS PAGES 248 AND 249 AS DOCUMENT NO. 294354, BEING LOCATED IN THE NORTHWEST, NORTHEAST, SOUTHWEST, AND SOUTHEAST 1/4'S OF THE NORTHWEST 1/4 OF SECTION 18, TOWN 3 NORTH, RANGE 17 EAST, TOWN OF LAFAYETTE, WALWORTH COUNTY, WISCONSIN.

OWNERS: CARL A. SR. AND DOLORES HAJEC
12970 12th AVE. NORTH
PLYMOUTH, MINN. 55441

MAPPING DATE 3-12-95
ZONING: C-3
SOILS: M₁A, D₁, S₁, H₁, CrE2, B₁C2

SURVEYED BY: ABERNATHY AND ASSOCIATES
W4056 BRAY RD.
ELKHORN, WI. 53121

LEGEND

- ☐ WALWORTH COUNTY SECTION CORNER FOUND
- FO. IRON ROD 3/4" DIA. 30' LONG. WEIGHING 1.50 lbs./lin. ft.
- ⚠ SOIL BORING

Q Found Iron Pipe

SCALE 1" = 200 FEET

GRAPHIC SCALE IN FEET



A horizontal scale bar with alternating black and white segments. Below the bar are numerical markings for 0, 100, 200, and 300 feet.

Lot 2 CSM 2510

ZONED C-3

66' WIDE STRIP SHOWN AS
A PRIVATE ROAD ON
EXISTING LAYOUT MAPS OF
RECORD.

N 30° 50' 35" E
39.41'

N 14° 12' 23" E
129.81'

65.369 S.F.
(UPLAND)

N 76° 37' 10" E

LOT 1
1.490 AC.
195.578 S.F.

S 56° 05' 05" E

Lot 4 CSM 2510

SEE DETAIL OF WETLANDS
BOUNDARY PAGE 2.

OVERHEAD UTILITY LINES

S 72° 08' 34" E
305.05'

N 14° 05' 41" W
80.75'

66'

ZONED C-3

Lot 4 CSM 2510

SEE DETAIL OF WETLANDS
BOUNDARY PAGE 2.

UTILITY LINES

ZONED C-3

C. S. #2578

PROJ. NO. 95.302
SHEET 1 OF 3 SH

VOLUME 13 PAGE 59

LOT 1 OF CERTIFIED SURVEY MAP NO. 2578 AS
RECORDED IN VOLUME 13 OF CERTIFIED SURVEY
MAPS AS PAGES 59, 60 AND 61 AS DOCUMENT
NO. 302675 WHICH IS A REPLATTING OF LOT 3
OF CERTIFIED SURVEY MAP NO. 2510 AS
RECORDED IN VOL. 12 OF CERTIFIED SURVEY
MAPS AS PAGES 248 AND 249 AS DOCUMENT NO.
294354, BEING LOCATED IN THE NORTHWEST,
NORTHEAST, SOUTHWEST, AND SOUTHEAST 1/4'S
OF THE NORTHWEST 1/4 OF SECTION 18, TOWN 3
NORTH, RANGE 17 EAST, TOWN OF
LAFAYETTE, WALWORTH COUNTY, WISCONSIN.

OWNERS: CARL AND DELORES HAJEC
12970 12th AVE. NORTH
PLYMOUTH, MINN. 55441

66' WIDE
PRIVATE ROAD

LOT 1
4.490 ac. total

WETLAND BOUNDARY

LOCATION DETERMINED BY S.E.M.R.P.C







NOTE:

FOR ADDITIONAL BOUNDARY INFORMATION SEE CERTIFIED
SURVEY MAP.

LINE	BEARING	DISTANCE
L1	N 56°04'56" E	17.18
L2	N 33°57'17" W	4.08
L3	N 39°51'48" W	14.31
L4	N 50°35'50" E	16.30
L5	N 14°49'44" W	33.61
L6	N 6°22'43" E	6.01
L7	N 76°37'10" E	12.95

"AS BUILT" FOUNDATION LOCATED 4/26/95.

Legend

-  FOUND IRON PIPE
 FOUND IRON ROD
 FOUND BRASS CAPPED MONUMENT
 FOUND CONCRETE MONUMENT
 CHISEL CUT IN CONCRETE
 SET IRON ROD, 24" LONG, WEIGHING 1.5 LBS./LINEAL FT., 3/4" DIA.
 SET IRON ROD, 30" LONG, WEIGHING 4.5 LBS./LINEAL FT., 1-11/16" DIA.

 [x x]
 — x — x —
 RECORDED AS DIMENSION
 EXISTING FENCE

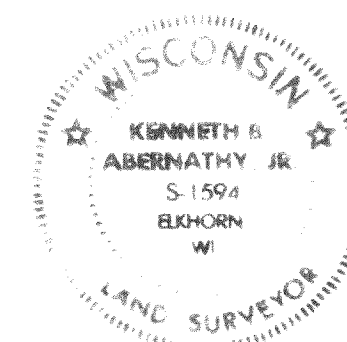

SCALE: 1" = 30 FEET

I hereby certify that the above described property has been surveyed by me or under my direction and that the above map is a true representation thereof and shows the size and location of the property, its exterior boundaries, the location of all visible structures and dimensions of all principal buildings thereon, boundary fences, apparent easements, roadways and visible encroachments, if any.

Kenneth B. Arnold

KENNETH B. ABERNATHY, JR.
WISCONSIN REGISTERED LAND SURVEYOR

Date: 4/26/95 Job No. S-1594 95.30

317-352