

Brookwood Lane

(66' Wide)

recorded as(N0°01'00"E 636.66')

10' Wide Utility Easement
As shown on C.S.M. 3159

(Arc=91.57')

(Chord Bears N11°14'30"W 90.88')

(N42°30'00"W)

(67.72')

No Direct Access
As shown on C.S.M. 3159

15' Wide Utility Easement
As shown on C.S.M. 3159

recorded as(S66°36'34"W 305.00')

Bray Road

(66' Wide)

Lot 2
C.S.M. 3159

recorded as(East 303.00')

Drainage Easement
As shown on C.S.M. 3159

(West 293.02')

Lot 1
Tax Parcel
KA315900001
(5.04 Acres)
(219,512 Sq.Ft.)

Found Rod 0.17' W. of line.
8.0'
92.45'
172.00'
172.10'
79.65'
Found Rod 0.15' W. of line.
91.00'
28.1'
20' Wide Drainage Easement
As shown on C.S.M. 3159
178.00'
177.83'
86.83'
Found Rod 0.10' W. of line.
(100.00')
100.23'
(91.14')
(91.14')
(28.95')
(10')
(10')

South 619.91'
recorded as(South 619.91')

Property Exhibit

of

The East Line of Lot 1 of Certified Survey Map No. 3159,

recorded November 11, 1999 in Vol. 17 of Certified Survey Maps of Walworth County on Page 186 as Document Number 431110 and located in the Southeast 1/4 and the Southwest 1/4 of the Northwest 1/4 and the Northeast 1/4 and the Northwest 1/4 of the Southwest 1/4 all in Section 33, Town 3 North, Range 17 East, Town of LaFayette, Walworth County, Wisconsin.

Surveyed for: **John Reiff**
N5130 Brookwood Lane
Elkhorn, Wisconsin. 53121

Lot 1
C.S.M. 3144

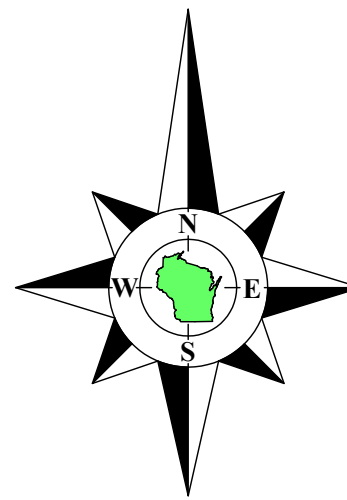

Bearings referenced to the East line of Lot 1 of Certified Survey Map No. 3159, recorded as North on said Certified Survey Map No. 3159.

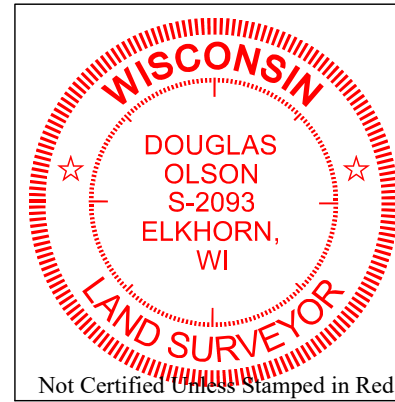

Notes:

- This Plat of Survey is not certified unless signed and sealed in red ink.
- This survey is subject to Wisconsin lien laws. This Plat of Survey is the notice of intent to file lien. Lien waiver required.
- The Survey Date shown on this Plat of Survey is the completion date of the field work.

Copyright © 2024 by Olson Land Surveying, LLC.

All rights reserved. No part of this survey plat may be reproduced or transmitted in any form by any means - graphic, electronic, or mechanical, including photocopying, tracing, or information storage and retrieval systems - without permission in writing from Douglas G. Olson, Olson Land Surveying, LLC.

I hereby certify that I have surveyed the above described property in compliance with Chapter A-E 7 of the Wisconsin Administrative Code and that the map hereon is correct to the best of my professional knowledge and belief and shows the size and location of the property, its exterior boundaries, the location and dimensions of all visible structures thereon, boundary fences, apparent easements and roadways and visible encroachments, if any.

This survey is made for the exclusive use of the present owners of the property, and also those who purchase, mortgage or guarantee title thereto, within one year from the date hereof.

Douglas G. Olson
Wisconsin Professional Land Surveyor - 2093

Sheet 1 of 1 Sheets

Drawing Name:

Job Reference Number
2023.122

Legend of Symbols & Abbreviations

- Found Iron Rod, 1-3/16" dia.
- Found Iron Rod, 3/4" dia.
- Set Iron Pipe, 1" dia.
- Recorded Information

N North
S South
E East
W West
In Bearings
° Degrees
' Minutes
" Seconds
In Distances
' Feet
" Inches



45 South Wisconsin Street | P.O. Box 322
Elkhorn, Wisconsin. 53121
Telephone: (262) 723-3434
Facsimile: (262) 723-8044
Email: doug@olsonsurveying.com
Website: www.olsonsurveying.com

Scale in Feet
1" = 40'



Survey Date: January 29, 2024.

Revisions:

2023.122