

Plat of Survey

of

Lot 1 of Certified Survey Map No. 2336,

recorded in Vol. 11 of Certified Survey Maps of Walworth County on Page 225 as Document No. 265233 and located in the Southeast 1/4 of the Southwest 1/4 of Section 6, Town 3 North, Range 17 East, Town of LaFayette, Walworth County, Wisconsin.

Surveyed for: **Anthony & Jenny Skemp**
N6933 Hodges Road
Elkhorn, Wisconsin. 53121

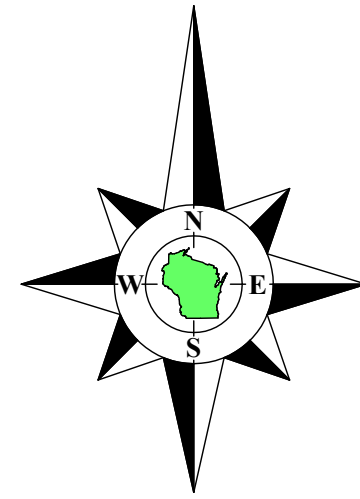

Bearings referenced to the South line of Certified Survey Map No. 2336, recorded as N88°39'16"W. A rotation of 3°29'38" from the Wisconsin State Plane Coordinate System, South Zone, (NAD-27).

Tax Parcel
KLF 600004

recorded as(N88°39'16"W 259.55')
S88°41'55"E 259.37'

recorded as(N1°20'44"E 81.38')
N1°22'53"E 81.44'

48.1'

Shed
40.2'

Shed
18.2'

House
N6933

Proposed
Addition
31'0"

Covered
Deck
19'2"

Well

N88°39'16"W 1015.96'
recorded as(N88°39'16"W 1015.96')

recorded as(East 748.93')
S89°59'13"E 748.95'

Lot 2
C.S.M. 2336

30' Wide Ingress & Egress Easement
As shown on Certified Survey
Map No. 2336.

Lot 1
Tax Parcel
KA233600001
6.852 Acres
298,491 Sq.Ft.

Hodges Road
(Width Varies)

S0°00'32"W 328.83'
recorded as(South 328.83')

South 1/4 Corner
Section 6-3-17
(N. 274,103.77)
(E. 2,393,656.30)

Tax Parcel
KLF 700002B

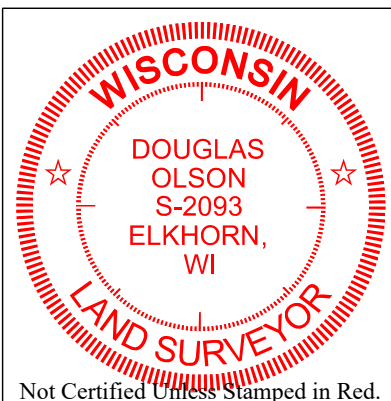

Notes:

- This Plat of Survey is not certified unless signed and sealed in red ink.
- This survey is subject to Wisconsin lien laws. This Plat of Survey is the notice of intent to file lien. Lien waiver required.
- The Survey Date shown on this Plat of Survey is the completion date of the field work.

Copyright © 2023 by Olson Land Surveying, LLC.

All rights reserved. No part of this survey plat may be reproduced or transmitted in any form by any means - graphic, electronic, or mechanical, including photocopying, tracing, or information storage and retrieval systems - without permission in writing from Douglas G. Olson, Olson Land Surveying, LLC.

I hereby certify that I have surveyed the above described property in compliance with Chapter A-E 7 of the Wisconsin Administrative Code and that the map hereon is correct to the best of my professional knowledge and belief and shows the size and location of the property, its exterior boundaries, the location and dimensions of all visible structures thereon, boundary fences, apparent easements and roadways and visible encroachments, if any.

This survey is made for the exclusive use of the present owners of the property, and also those who purchase, mortgage or guarantee title thereto, within one year from the date hereof.

Douglas G. Olson
Wisconsin Professional Land Surveyor - 2093

Legend of Symbols & Abbreviations

- Found County Section Corner
- Found Iron Rod, 1-3/4" dia.
- Recorded Information
- Utility Pole
- Concrete Cover
- Asphalt Surface
- Gravel Surface
- Brick Pavement

Sheet 1 of 1 Sheets

Job Reference Number
2023.055

2023.055

OLSON
LAND SURVEYING, LLC
Rural | Residential | Commercial

45 South Wisconsin Street | P.O. Box 322
Elkhorn, Wisconsin 53121
Telephone: (262) 723-3434
Facsimile: (262) 723-8044
Email: doug@olsonsurveying.com
Website: www.olsonsurveying.com

Scale in Feet
1" = 30'



Survey date: August 10, 2023
Revisions: No. 1 - Proposed House Addition
No. 2 - Adjusted Deck