

PLAT OF SURVEY -OF-

LOT 83 OF EVERGREEN ESTATES, ACCORDING TO THE
RECORDED PLAT THEREOF. SAID LAND BEING IN THE
TOWN OF LAFAYETTE, COUNTY OF WALWORTH AND
STATE OF WISCONSIN.

SURVEY FOR: KRISTIN BALICKI
PROPOSED ADDRESS: SPRUCE LANE

BEARINGS HEREON RELATE TO THE EAST LINE
OF LOT 83 OF EVERGREEN ESTATES, ASSUMED
BEARING SOUTH 00°13'00" EAST.

LEGEND

- FOUND IRON PIPE
- FOUND IRON ROD
- ⊘ SET IRON PIPE
- △ SOIL BORING
- () RECORDED AS

GRAPHIC SCALE

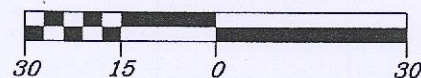

SCALE: 1" = 30'

"I hereby certify that I have surveyed the above described
property and that the above map is a correct representation thereof
and shows the size and location of the property, its exterior
boundaries, the location of all visible structures and dimensions
of all principal buildings thereon, boundary fences, apparent
easements, roadways and encroachments, if any."

"This survey is made for the use of the present owners of the
property, and those who purchase, mortgage, or guarantee the
title thereto within one year from date hereof."

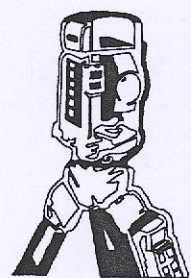

B.W. SURVEYING, INC.

LAND SURVEYS
MAPPING AND PLANNING
412 N. PINE STREET
BURLINGTON, WI 53105
(262)-767-0225

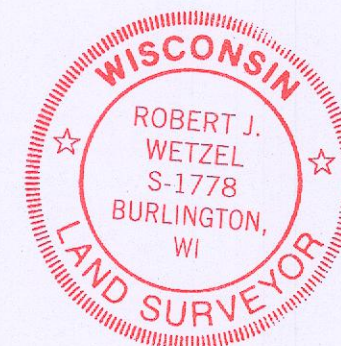
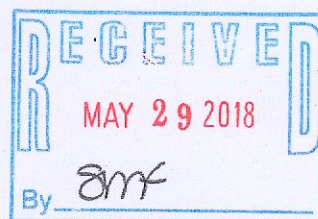

THIS IS NOT AN ORIGINAL PRINT
UNLESS THIS SEAL IS RED.

Robert J. Wetzel
ROBERT J. WETZEL S-1778

SEPTEMBER 19, 2017
DATE

9454
JOB NUMBER

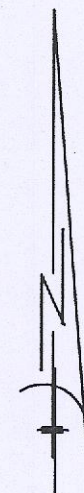

SPRUCE
LANE
(66' WIDE)

CHORD = 103.89'
R = 602.29'
L = 106.00'
N21°56'11.3"W
N21°56'37.7"W

UTILITY
BOXES

VACANT

(N64°57'56"E
N64°56'41"E

UTILITY
EASEMENT

226.51'
226.31'

UTILITY
EASEMENT

S00°13'00"E

152.87'
(153.00')

12'

146.86'

S76°03'11"W
(S76°08'02"W
171.06'
171.24')

KE-83

317-1075