

Plat of Survey

of
Unit 45 of Phase 2 Rolling Green Country Estates,
a condominium located in the Southwest 1/4 and the Southeast 1/4 of Section 18, Town 3
North, Range 17 East, Town of LaFayette, Walworth County, Wisconsin.

Surveyed for: **Greg & Sue Equi**
P.O. Box 874
East Troy, Wisconsin. 53120

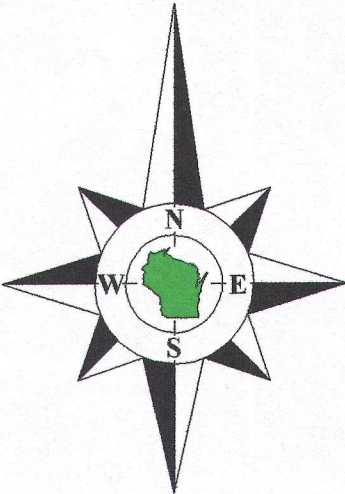

Bearings reference to the condominium plat
of Phase 2 Rolling Green Country Estates.

House
W4699

Unit 46

Deck

Poured
Concrete
Foundation
W4691

Unit 45
Tax Parcel
KRG 00045
0.832 Acre
36,247 Sq.Ft.

Tax Parcel
KLF 18000040

- Notes:
- 1) This survey plat is not certified unless signed and sealed in red ink.
 - 2) This survey is subject to Wisconsin lien laws. This Plat of Survey is the notice of intent to file lien. Lien waiver required.

Copyright 2015 by Olson Land Surveying, LLC.

All rights reserved. No part of this survey plat may be reproduced or transmitted in any form by any means - graphic, electronic, or mechanical, including photocopying, tracing, or information storage and retrieval systems - without permission in writing from Douglas G. Olson, Olson Land Surveying, LLC.

I, Douglas G. Olson, Wisconsin Professional Land Surveyor, do hereby certify that this survey was performed by me, or under my direction in full compliance with the owner's/agent's instructions and Chapter A-E 7 of the Wisconsin Administrative Code "Minimum Standards for Property Surveys"; and that this map is an accurate representation thereof to the best of my knowledge and belief.

Douglas G. Olson
Wisconsin Professional Land Surveyor - 2093

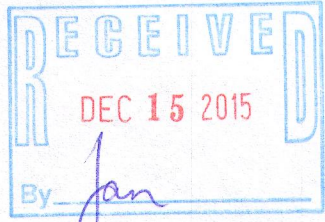
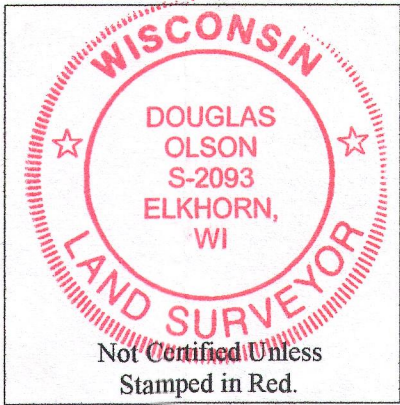

Sheet 1 of 1 Sheets

Drawing Name:

Job Reference Number

Legend

- Found Iron Pipe
- Set Wood Stake - 04-16-15
- Recorded Information
- Utility Box or Pedestal
- Control Valve



Olson Land Surveying, LLC

45 South Wisconsin Street * P.O. Box 322 * Elkhorn, Wisconsin. 53121
Telephone: (262) 723-3434 * Facsimile: (262) 723-8044

Scale in Feet
1" = 20'

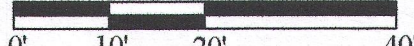

Survey Date: March 10, 2015.
Revisions: No. 1 - Setback lines and
Proposed House
No. 2 - Proposed House
No. 3 - Proposed House
No. 4 - Proposed House
No. 5 - Proposed House
Modified & Co.