

PLAT OF SURVEY

LOT 4 OF BLOCK 11 OF COOL HILL PARK SECOND ADDITION, A SUBDIVISION LOCATED IN THE NORTHEAST 1/4 OF SECTION 3, TOWN 3 NORTH, RANGE 16 EAST AND IN THE SOUTHEAST 1/4 OF SECTION 34, TOWN 4 NORTH, RANGE 16 EAST, WALWORTH COUNTY, WISCONSIN.

OWNER: MICHAEL LYON
2444 AUGUST DRIVE
ELKHORN, WI. 53121

ORDERED BY: JAMES STREIB, CONTRACTOR
RT. 1 BOX 4
ELKHORN, WI. 53121

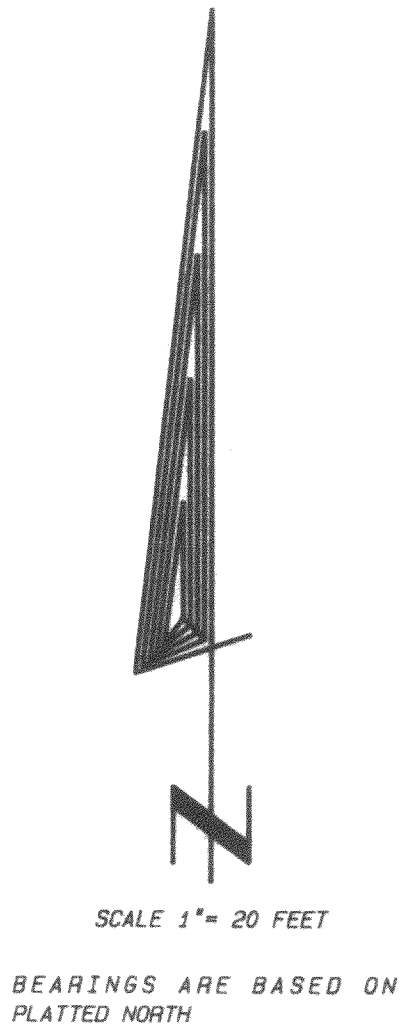

- Legend
- FOUND IRON PIPE
 - FOUND IRON ROD
 - FOUND BRASS CAPPED MONUMENT
 - FOUND CONCRETE MONUMENT
 - CHISEL CUT IN CONCRETE
 - SET IRON ROD, 24" LONG, WEIGHING 1.5 LBS./LINEAL FT., 3/8" DIA.
 - SET IRON ROD, 30" LONG, WEIGHING 8.5 LBS./LINEAL FT., 1-11/16" DIA.
 - RECORDED AS DIMENSION
 - EXISTING FENCE

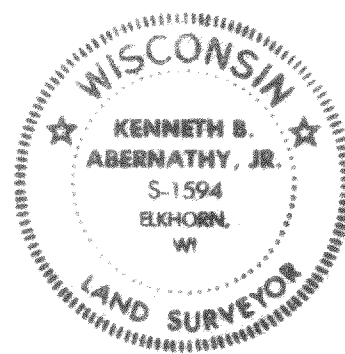
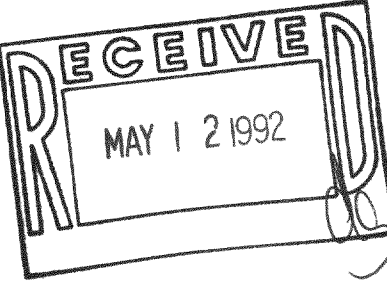

"I hereby certify that I have surveyed the above described property and that the above map is a true representation thereof and shows the size and location of the property, its exterior boundaries, the location of all visible structures and dimensions of all principal buildings thereon, boundary fences, apparent easements, roadways and visible encroachments, if any."

"This survey is made for the use of the present owners of the property, and also those who purchase, mortgage, or guarantee the title thereto within one year from date hereof."

Kenneth B. Abernathy Jr.
KENNETH B. ABERNATHY, JR.
WISCONSIN REGISTERED LAND SURVEYOR,
S-1594
Date: OCTOBER 26, 1991 Job No. 91-015