

GEORGE T. DUNHAM
SURVEYING & SUBDIVIDING
DELAVER, WISCONSIN

DAFFODIL ROAD

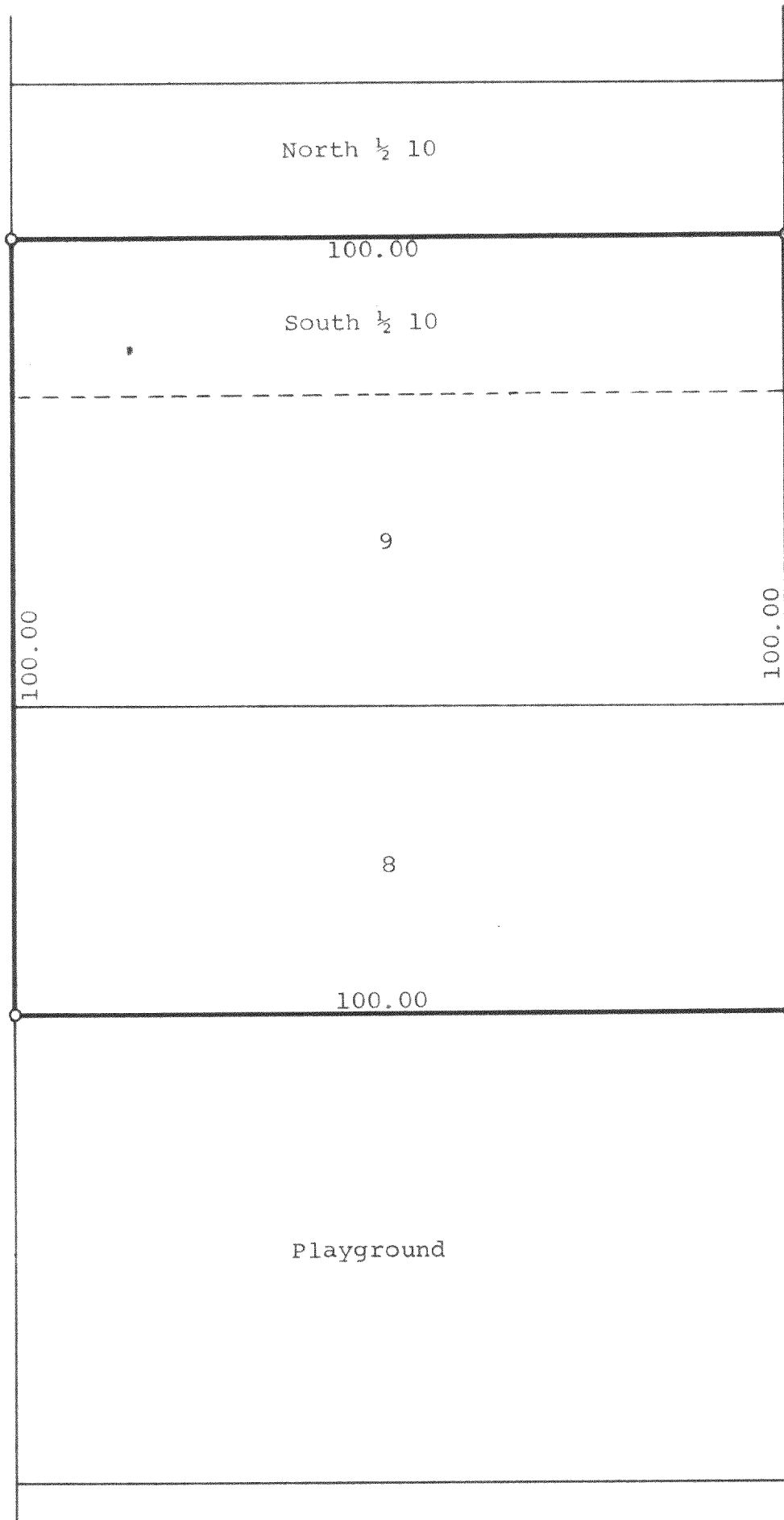

N

Scale - 1" = 20'
○ = Iron Pipe

Plat of survey of Lot 8, 9, and the South $\frac{1}{2}$ of Lot 10,
Block 5 of Interlaken, a subdivision located in the
Town of Sugar Creek, Walworth County, Wisconsin.
November 25, 1966

George T. Dunham
George T. Dunham, Surveyor

316-32