

Plat of Survey

of
Unit 40 of Lauderdale Lakes Estates,
a condominium recorded June 30, 1995 in Cab. A of Condominiums of Walworth County on Slide 249 as Document Number 308535 and located in the Northwest 1/4 and the Southwest 1/4 of the Southeast 1/4 of Section 1, Town 3 North, Range 16 East, Town of Sugar Creek, Walworth County, Wisconsin.

Surveyed for:
S&S Concrete Walworth County, LLC
N6719 Walnut Road
Elkhorn, Wisconsin. 53121

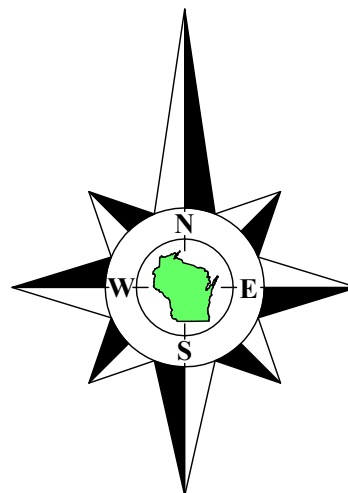

Bearings referenced to the North line of Northwood Drive, recorded as S79°22'38"W on the plat of Lauderdale Lakes Estates.

Unit 40
Tax Parcel
GLLE 00017
1.079 Acres
47,021 Sq.Ft.

Lakeshore Avenue
(66' Wide)

Northwood Drive
(66' Wide)

Notes:

- This Plat of Survey is not certified unless signed and sealed in red ink.
- This survey is subject to Wisconsin lien laws. This Plat of Survey is the notice of intent to file lien. Lien waiver required.
- The Survey Date shown on this Plat of Survey is the completion date of the field work.

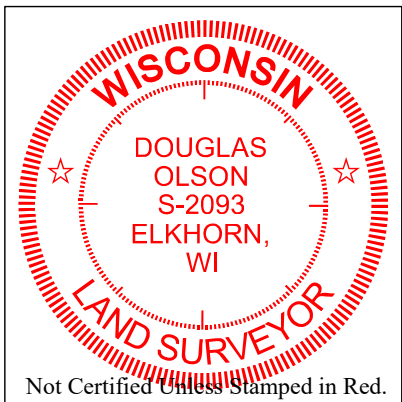

Copyright ©2024 by Olson Land Surveying, LLC.

All rights reserved. No part of this survey plat may be reproduced or transmitted in any form by any means - graphic, electronic, or mechanical, including photocopying, tracing, or information storage and retrieval systems - without permission in writing from Douglas G. Olson, Olson Land Surveying, LLC.

I hereby certify that I have surveyed the above described property in compliance with Chapter A-E 7 of the Wisconsin Administrative Code and that the map hereon is correct to the best of my professional knowledge and belief and shows the size and location of the property, its exterior boundaries, the location and dimensions of all visible structures thereon, boundary fences, apparent easements and roadways and visible encroachments, if any.

This survey is made for the exclusive use of the present owners of the property, and also those who purchase, mortgage or guarantee title thereto, within one year from the date hereof.

Douglas G. Olson
Wisconsin Professional Land Surveyor - 2093

Sheet 1 of 1 Sheets

Drawing Name:

Job Reference Number
2024.139

Legend of Symbols & Abbreviations

- Found Iron Pipe, 2" dia.
- Found Iron Pipe, 1" dia.
- Set Iron Pipe, 1" dia.
- Recorded Information
- Utility Pedestal
- Asphalt Surface

N North
S South
E East
W West
In Bearings
° Degrees
' Minutes
" Seconds
In Distances
' Feet
" Inches



45 South Wisconsin Street | P.O. Box 322
Elkhorn, Wisconsin. 53121
Telephone: (262) 723-3434
Facsimile: (262) 723-8044
Email: doug@olsonsurveying.com
Website: www.olsonsurveying.com

Scale in Feet
1" = 20'



Survey Date: November 20, 2024.

Revisions: No. 1 - Proposed House & Zoning Info.
No. 2 - Proposed House Moved 27' East

2024.139