

of  
**Lot 20 of Charl-Mar Subdivision,**

Surveyed for: **Margarito Viguera**  
W5005 Paddock Drive  
Elkhorn, Wisconsin. 53121

recorded as(N60°14'E 230.03')Plat  
**N60°09'14"E 229.57'**  
 N60°14'35"E 230.21 Between Pipe  
 recorded as(N60°14'E 230.03')Plat

**Lot 20**

**Tax Parcel**  
**GCH 00020**

0.753 Acre  
32,795 Sq.Ft.

**House**  
**W5005**

Well

3.31' 19.4' 2.8' 1.4' 15.6' 1.4' 30.4' 25.4'

Gas Meter Elec. Meter

AC

Hot Tub

Patio

Fire Pit

recorded as (N85°27'E 188.49') Plat  
N85°15'34"E 188.72'  
**S85°15'34"W 186.64'**  
recorded as (N85°27'E 188.49') Plat

I hereby certify that I have surveyed the above described property in compliance with Chapter A-E 7 of the Wisconsin Administrative Code and that the map hereon is correct to the best of my professional knowledge and belief and shows the size and location of the property, its exterior boundaries, the location and dimensions of all visible structures thereon, boundary fences, apparent easements and roadways and visible encroachments, if any.

This survey is made for the exclusive use of the present owners of the property, and also those who purchase, mortgage or guarantee title thereto, within one year from the date hereof.

Found Iron pipe is on the computed East line of Charl-Mar Subdivision and is 0.75' E. of the monumented line.

As shown on the plat of  
Charl-Mar Subdivision.

recorded as(S0°29'44"E 1304.88')CSM 3497  
recorded as(N0°52'30"W 1305.09')Plat

S0°33'14"E 1304.79' Between Pipe  
East line of Charl-Mar Subdivision as monumented  
with Iron Pipe at the time the plat was recorded.

(164.92')

Lot 1  
C.S.M. 3497

See extensive measurements and notes regarding the location of the East line of Charl-Mar Subdivision on a Plat of Survey of Lot 8 of Charl-Mar Subdivision dated June 30, 2021, and filed with Walworth County as survey number 316-2515. The East line of Charl-Mar Subdivision used on this survey is the same as used on that survey and as monumented with Iron Pipe at the time the plat was recorded which is also the West line of C.S.M. 3497.

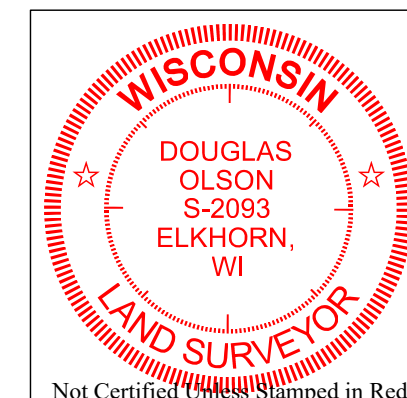

- 1) This Plat of Survey is not certified unless signed and sealed in red ink.
- 2) This survey is subject to Wisconsin lien laws. This Plat of Survey is the notice of intent to file lien. Lien waiver required.
- 3) The Survey Date shown on this Plat of Survey is the completion date of the field work.

All rights reserved. No part of this survey plat may be reproduced or transmitted in any form by any means - graphic, electronic, or mechanical, including photocopying, tracing, or information storage and retrieval systems - without permission in writing from Douglas G. Olson, Olson Land Surveying, LLC.

Scale in feet  
1" = 20'



0' 10' 20' 40' 60'

45 South Wisconsin Street | P.O. Box 322  
Elkhorn, Wisconsin. 53121  
Telephone: (262) 723-3434  
Facsimile: (262) 723-8044  
Email: [doug@olsonsurveying.com](mailto:doug@olsonsurveying.com)  
Website: [www.olsonsurveying.com](http://www.olsonsurveying.com)

**OLSON**  
LAND SURVEYING, LLC  
Rural | Residential | Commercial

☐ Found Iron Pipe, 2" dia.  
☐ Found Iron Pipe, 1" dia.  
☐ Recorded Information  
☒ Utility Box or Pedestal  
☐ Concrete Cover  
☐ Septic Vent  
☒ Soil Boring  
☐ Asphalt Surface  
☐ Concrete Surface

N North  
 S South  
 E East  
 W West  
 In Bearings  
 Degrees  
 ' Minutes  
 " Seconds  
 In Distances  
 Feet  
 " Inches

2024.049

Sheet 1 of 1 Sheets

Drawing Name:

Job Reference Number

2024.049