

Plat of Survey

of

Lot 1 of Certified Survey Map No. 3664,

recorded in Vol. 22 of Certified Survey Maps of Walworth County on Page 13 as Document No. 594001 and located in the Southwest 1/4 of the Southeast 1/4 of Section 24, Town 3 North, Range 16 East, Town of Sugar Creek, Walworth County, Wisconsin.

Surveyed for: **Scott Simons**
N5704 Voss Road
Elkhorn, Wisconsin. 53121

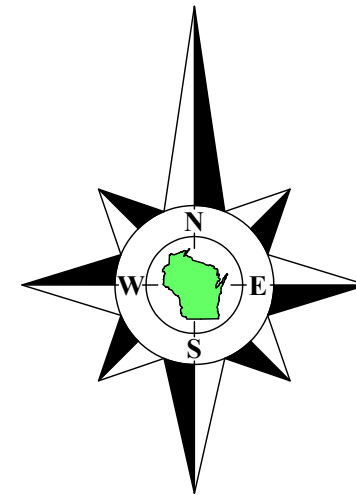

Bearings referenced to the West line of the Southeast 1/4 of Section 24-3-16, recorded as N2°08'12"W in the Wisconsin State Plane Coordinate System, South Zone, (NAD-27).

Coordinates are referenced to the Wisconsin State Plane Coordinate System, South Zone, (NAD-27).

Tax Parcel
GSC 2400007

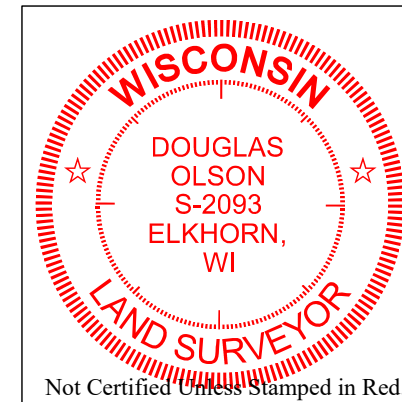

Notes:

- 1) This Plat of Survey is not certified unless signed and sealed in red ink.
- 2) This survey is subject to Wisconsin lien laws. This Plat of Survey is the notice of intent to file lien. Lien waiver required.
- 3) The Survey Date shown on this Plat of Survey is the completion date of the field work.

Copyright © 2023 by Olson Land Surveying, LLC.

All rights reserved. No part of this survey plat may be reproduced or transmitted in any form by any means - graphic, electronic, or mechanical, including photocopying, tracing, or information storage and retrieval systems - without permission in writing from Douglas G. Olson, Olson Land Surveying, LLC.

I hereby certify that I have surveyed the above described property in compliance with Chapter A-E 7 of the Wisconsin Administrative Code and that the map hereon is correct to the best of my professional knowledge and belief and shows the size and location of the property, its exterior boundaries, the location and dimensions of all visible structures thereon, boundary fences, apparent easements and roadways and visible encroachments, if any.

This survey is made for the exclusive use of the present owners of the property, and also those who purchase, mortgage or guarantee title thereto, within one year from the date hereof.

Douglas G. Olson
Wisconsin Professional Land Surveyor - 2093

Survey Date: September 26, 2023.
Revisions: No. 1 - Proposed Barn

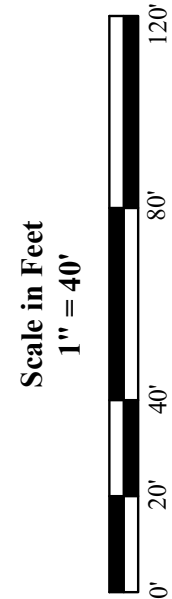

45 South Wisconsin Street | P.O. Box 322
Elkhorn, Wisconsin. 53121
Telephone: (262) 723-3434
Facsimile: (262) 723-8044
Email: doug@olsonsurveying.com
Website: www.olsonsurveying.com



Legend of Symbols & Abbreviations	
Found County Section Corner	N North
Found Iron Pipe, 1" dia.	S South
Set Iron Pipe, 1" dia.	E East
Recorded Information	W West
Utility Pole	In Bearings
Utility Pedestal or Manhole	in Degrees
Asphalt Surface	in Seconds
Concrete Surface	in Feet
Gravel Surface	in Inches
Brick Pavers	

Sheet 1 of 1 Sheets

Drawing Name:

Job Reference Number

2023.078

2023.078