

Plat of Survey

Lots 15 & 16 in Block 6 of Lake Wandawega Highlands,

a subdivision located in Government Lot 1 in the Northeast 1/4 of Section 11, Town
3 North, Range 16 East, Town of Sugar Creek, Walworth County, Wisconsin.

Surveyed for:

S&S Concrete Walworth County, LLC

N6719 Walnut Road
Elkhorn, Wisconsin. 53121

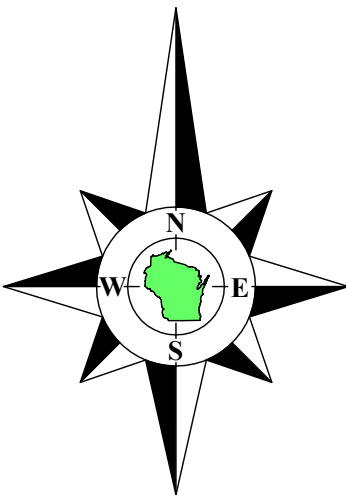

Bearings referenced to the South lines of Lots 15
and 16, recorded as N89°10'E on the plat of Lake
Wandawega Highlands.

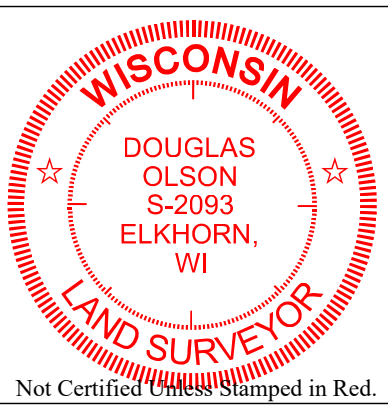

Notes:

- 1) This Plat of Survey is not certified unless signed and sealed in red ink.
- 2) This survey is subject to Wisconsin lien laws. This Plat of Survey is the notice of intent to file lien. Lien waiver required.
- 3) The Survey Date shown on this Plat of Survey is the completion date of the field work.

Copyright ©2022 by Olson Land Surveying, LLC.

All rights reserved. No part of this survey plat may be reproduced or transmitted in any form by any means - graphic, electronic, or mechanical, including photocopying, tracing, or information storage and retrieval systems - without permission in writing from Douglas G. Olson, Olson Land Surveying, LLC.

I hereby certify that I have surveyed the above described property in compliance with Chapter A-E 7 of the Wisconsin Administrative Code and that the map hereon is correct to the best of my professional knowledge and belief and shows the size and location of the property, its exterior boundaries, the location and dimensions of all visible structures thereon, boundary fences, apparent easements and roadways and visible encroachments, if any.

This survey is made for the exclusive use of the present owners of the property, and also those who purchase, mortgage or guarantee title thereto, within one year from the date hereof.

Douglas G. Olson
Wisconsin Professional Land Surveyor - 2093

No. 7 - Concrete Forms
No. 8 - House Under Construction

Survey Date: June 13, 2022.
Revisions: No. 1 - Proposed House Moved East
No. 2 - Proposed House Moved East
No. 3 - Proposed House Moved East
No. 4 - Boring
No. 5 - Permit Info.
No. 6 - Bigger House as Staked in Hole
continued above.

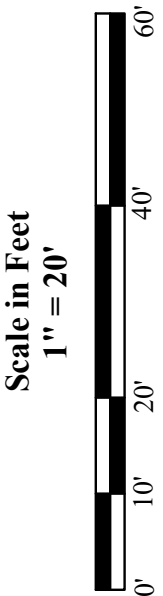

45 South Wisconsin Street | P.O. Box 322
Elkhorn, Wisconsin. 53121
Telephone: (262) 723-3434
Facsimile: (262) 723-8044
Email: doug@olsonsurveying.com
Website: www.olsonsurveying.com

OLSON
LAND SURVEYING, LLC
Rural | Residential | Commercial

Legend of Symbols & Abbreviations
Found Concrete Monument North
Found Iron Pipe 1" dia. South
Found Iron Rod 1/2" dia. East
Set Iron Pipe 1" dia. West
Recorded Information In Degrees
Utility Box Minutes
Asphalt Surface In Distances
Gravel Surface Feet
Batters In Feet
Set Wood Stake in Hole 0" - 11" - 24" Inches

Sheet 1 of 1 Sheets
Drawing Name:
Job Reference Number
2022.065

2022.065