

Cedar Road

(50' Wide)

Daffodil Road

(50' Wide)

Block 4

Lot 3

Lot 32

Tax Parcel
GI 00038A

0.321 Acre
14,000 Sq.Ft.

Proposed House

Lot 4

Lot 5

Tax Parcel
GI 00021

Lot 1

Lot 2

Lot 8

Tax Parcel

GI 00023

Lot 7

Lot 30

Tax Parcel
GI 00037

Lot 31

Lot 9

Lot 29

Park Drive

(50' Wide)

Copyright ©2023 by Olson Land Surveying, LLC.

All rights reserved. No part of this survey plat may be reproduced or transmitted in any form by any means - graphic, electronic, or mechanical, including photocopying, tracing, or information storage and retrieval systems - without permission in writing from Douglas G. Olson, Olson Land Surveying, LLC.

Plat of Survey

of

**Lots 4, 5, 32 and the East 1/2 of Lot 3,
all in Block 4 of the Map of Interlaken,**

a subdivision located in Government Lot 4 in the Southwest
1/4 of Section 11, Town 3 North, Range 16 East, Town of
Sugar Creek, Walworth County, Wisconsin.

Surveyed for: **Miguel A. Ortiz Roman**
1105 North Church Street Apt. 101
Elkhorn, Wisconsin. 53121

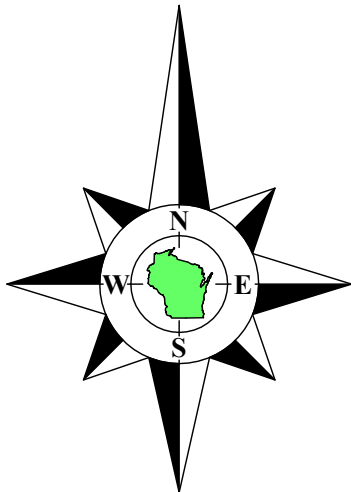

Bearings reference to the
Map of Interlaken.

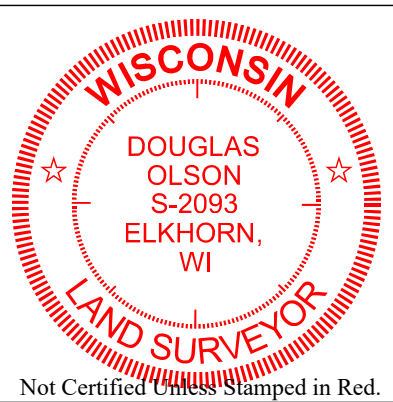

Notes:

- 1) This Plat of Survey is not certified unless signed and sealed in red ink.
- 2) This survey is subject to Wisconsin lien laws. This Plat of Survey is the notice of intent to file lien. Lien waiver required.
- 3) The Survey Date shown on this Plat of Survey is the completion date of the field work.

I hereby certify that I have surveyed the above described property in compliance with Chapter A-E 7 of the Wisconsin Administrative Code and that the map hereon is correct to the best of my professional knowledge and belief and shows the size and location of the property, its exterior boundaries, the location and dimensions of all visible structures thereon, boundary fences, apparent easements and roadways and visible encroachments, if any.

This survey is made for the exclusive use of the present owners of the property, and also those who purchase, mortgage or guarantee title thereto, within one year from the date hereof.

Douglas G. Olson
Wisconsin Professional Land Surveyor - 2093

Survey Date: June 21, 2023.
Revisions:



45 South Wisconsin Street | P.O. Box 322
Elkhorn, Wisconsin. 53121
Telephone: (262) 723-3434
Facsimile: (262) 723-8044
Email: doug@olsonsurveying.com
Website: www.olsonsurveying.com



Legend of Symbols & Abbreviations	
Found Concrete Monument	North
Found Iron Pipe	Set Wood Stake
Found Iron Pipe, 1" dia.	Set Iron Pipe, 1" dia.
Recorded Information	Recorded Information
Utility Pole	Utility Pole
Utility Pedestal	Utility Pedestal
Catch Basin	Catch Basin
Asphalt Surface	Gravel Surface

Sheet 1 of 1 Sheets

Drawing Name:
Job Reference Number
2023.027

2023.027