

# Plat of Survey

of

## Lot 1 of Certified Survey Map No. 3433,

recorded in Vol. 20 of Certified Survey Maps of Walworth County on Page 13 and located in the Northwest 1/4 of Section 2, Town 3 North, Range 16 East, Town of Sugar Creek, Walworth County, Wisconsin.

Surveyed for: **The Rauland Agency, Inc.**

118 Kenosha Street \* P.O. Box 159  
Walworth, Wisconsin. 53184

### Lost Nation Drive

North line of the Northwest 1/4 Section 2-3-16.

(66' Wide)

Overhead Wires

Wire Fence

N89°03'40"E 188.00'

Access restriction as shown on Certified Survey Map No. 3433.

N88°47'12"E  
125.37'

**Lot 1**  
**Tax Parcel**  
**GA343300001**

1.673 Acres  
72,866 Sq.Ft.

Lot 1  
C.S.M. 2661

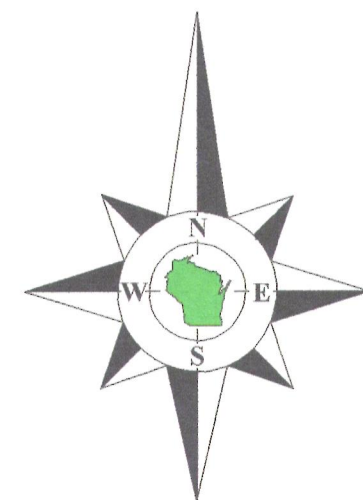

Bearings reference to Certified  
Survey Map No. 3433.

Lot 2  
C.S.M. 3433

N0°56'52"W 392.44'

**Garage**

**House**  
W5587

**Deck**

**Well**

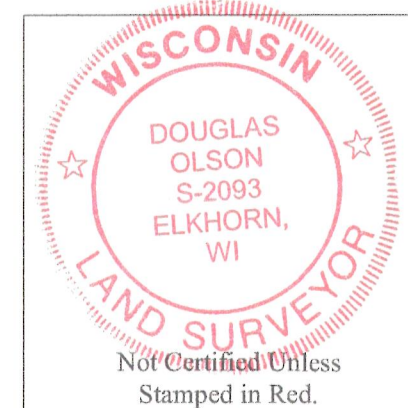

Not Certified Unless  
Stamped in Red.

#### Notes:

- 1) This survey plat is not certified unless signed and sealed in red ink.
- 2) This survey is subject to Wisconsin lien laws. This Plat of Survey is the notice of intent to file lien. Lien waiver required.



Copyright 2012 by Jensen & Olson Land Surveying, LLC.

Lot 2  
C.S.M. 2661

All rights reserved. No part of this survey plat may be reproduced or transmitted in any form by any means - graphic, electronic, or mechanical, including photocopying, tracing, or information storage and retrieval systems - without permission in writing from Douglas G. Olson, Jensen & Olson Land Surveying, LLC.

I hereby certify that I have surveyed the above described property and the map hereon is correct to the best of my professional knowledge and belief and shows the size and location of the property, its exterior boundaries, the location and dimensions of all visible structures thereon, boundary fences, apparent easements and roadways and visible encroachments, if any.

This survey is made for the exclusive use of the present owners of the property, and also those who purchase, mortgage or guarantee title thereto, within one year from the date hereof.

Douglas G. Olson  
Wisconsin Registered Land Surveyor - 2093

Sheet 1 of 1 Sheets

Drawing Name: Gar16e-2012096-2012096Plat.scd

Job Reference Number  
**2012.096**

#### Legend

- Found County Section Corner
- Found Iron Pipe
- Found Iron Rod
- Recorded Information
- Utility Pole
- Concrete Cover
- Utility Box or Pedestal
- Septic Cap or Vent
- Asphalt Surface
- Concrete Surface
- Gravel



**Jensen & Olson Land Surveying, LLC**

45 South Wisconsin Street \* P.O. Box 322 \* Elkhorn, Wisconsin. 53121

Telephone: (262) 723-3434 \* Facsimile: (262) 723-8044

Email: jensen.olson@elknet.net

Scale in Feet  
1" = 30'

0' 15' 30' 60'

Survey Date: August 16, 2012.

Revisions:

2012.096

GA3433 -1

316-8128