

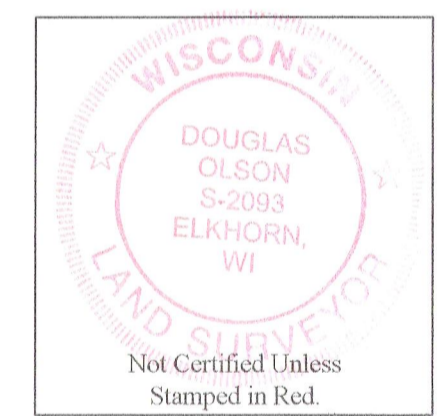

Plat of Survey

of
**The East Line of Lot 35 in Block 5
 of North Lake Shore-Woods,**
 a subdivision located in the Northeast 1/4 of Section 5, Town 3 North,
 Range 16 East, Town of Sugar Creek, Walworth County, Wisconsin.

Surveyed for:
Kettle Moraine Land Trust, Ltd.
 N7622 Pleasant Point Circle
 Elkhorn, Wisconsin. 53121

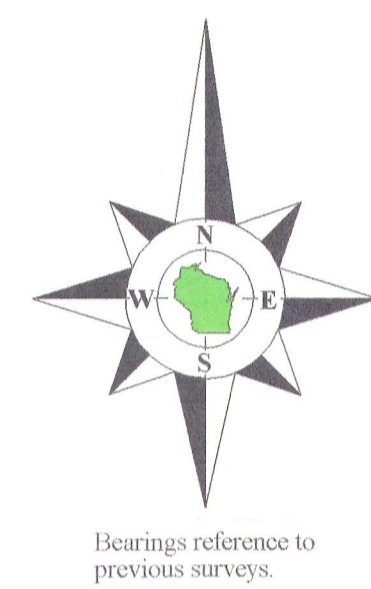

- Notes:**
- 1) This survey plat is not certified unless signed and sealed in red ink.
 - 2) This survey is subject to Wisconsin lien laws. This Plat of Survey is the notice of intent to file lien. Lien waiver required.

Copyright 2011 by Jensen & Olson Land Surveying, LLC.

All rights reserved. No part of this survey plat may be reproduced or transmitted in any form by any means - graphic, electronic, or mechanical, including photocopying, tracing, or information storage and retrieval systems - without permission in writing from Douglas G. Olson, Jensen & Olson Land Surveying, LLC.

I, Douglas G. Olson, Wisconsin Registered Land Surveyor, do hereby certify that this survey was performed by me, or under my direction in full compliance with the owner's/agent's instructions and Chapter A-E 7 of the Wisconsin Administrative Code "Minimum Standards for Property Surveys"; and that this map is an accurate representation thereof to the best of my knowledge and belief.

Douglas G. Olson
 Wisconsin Registered Land Surveyor - 2093



GNLS-48

316-2105

Survey Date: July 15, 2011.
 Revisions:

Scale in Feet
 1" = 20'
 0' 10' 20' 40'

Jensen & Olson Land Surveying, LLC
 45 South Wisconsin Street * P.O. Box 322 * Elkhorn, Wisconsin. 53121
 Telephone: (262) 723-3434 * Facsimile: (262) 723-8044
 Email: jensen.olson@elknet.net

Legend
 Found Iron Pipe
 Found Iron Rod
 Set Wood Lath
 Recorded Information
 Asphalt Surface
 Concrete Surface

Sheet 1 of 1 Sheets
 Drawing Name: Gar16-2011-059-2011-059Plat.sld
 Job Reference Number
2011.059

2011.059