

Plat of Survey

of

The West 1/2 of Lot 10, Lots 11 and 12, the East 1/2 of Lot 13, Lots 21 and 22, the West 1/2 of Lot 23, all of Block 43 of Interlaken,

a subdivision located in the Northwest 1/4 of Section 11, Town 3 North, Range 16 East, Town of Sugar Creek, Walworth County, Wisconsin.

Surveyed for: **Michael & Carolyn Sharpe**
 W5512 Barley Road
 Elkhorn, Wisconsin, 53121

Survey date: September 27, 2007.
 Revisions: No. 1 - No Lot Line Adjustment

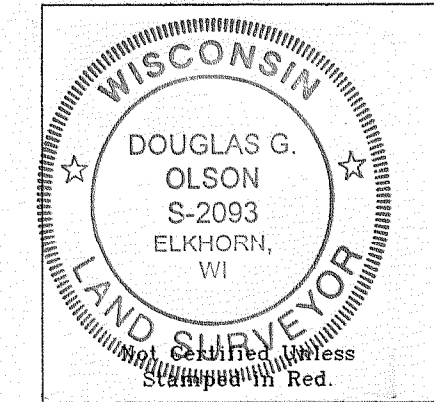
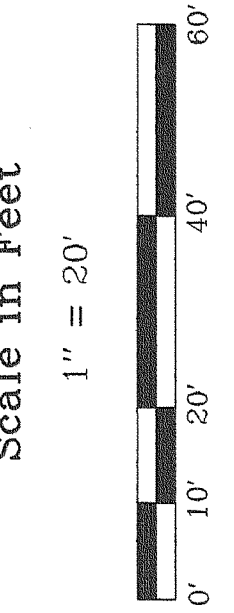

Notes: 1) This survey plat is not certified unless signed and sealed in red ink.
 2) This survey is subject to Wisconsin lien laws. This Plat of Survey is the notice of intent to file lien. Lien waiver required.

Copyright © 2007 by Jensen & Olson Land Surveying, LLC.
 All rights reserved. No part of this survey plat may be reproduced or transmitted in any form by any means - graphic, electronic, or mechanical, including photocopying, tracing, or information storage and retrieval systems - without permission in writing from Douglas G. Olson, Jensen & Olson Land Surveying, LLC.

I hereby certify that I have surveyed the above described property and the map hereon is correct to the best of my professional knowledge and belief and shows the size and location of the property, its exterior boundaries, the location and dimensions of all visible structures thereon, boundary, boundary fences, apparent easements and roadways and visible encroachments, if any.
 This survey is made for the exclusive use of the present owners of property, and also those who purchase, mortgage or guarantee title thereto, within one year from the date hereof.

Douglas G. Olson
 Wisconsin Registered Land Surveyor - 2093

Jensen & Olson Land Surveying, LLC
 45 South Wisconsin Street
 P.O. Box 322
 Elkhorn, Wisconsin, 53121
 Telephone: (262) 723-3434
 Facsimile: (262) 723-8044

- Legend**
- Found Concrete Monument
 - Found Iron Pipe
 - Set Iron Rod 3/4" dia.
 - () Recorded Information
 - X Utility Pole
 - Lamp
 - ⊗ Asphalt Surface
 - ⊘ Gravel Surface

Sheet 1 of 1 Sheets.
 Job Reference Number
2007.127

2007.127

GI 307A - GI 303 GI 314

316-1971