

Plat of Survey

of

Lot 21 of Baywood Estates,

a subdivision located in the Northeast 1/4 of Section 2, Town 3 North,
Range 16 East, Town of Sugar Creek, Walworth County, Wisconsin.

Surveyed for: **Duane Novak**
263 Westward Drive
Elkhorn, Wisconsin. 53121

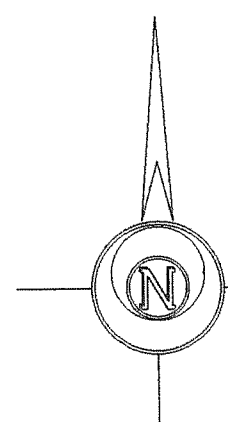

Bearings reference to the
plat of Baywood Estates.

Lauderdale
Lake

Lot 21
0.665 Acre
28,984 Sq.Ft.

House
W5336

Deck

Deck

Deck

Well

Timber

Plantation Road
(66' Wide)

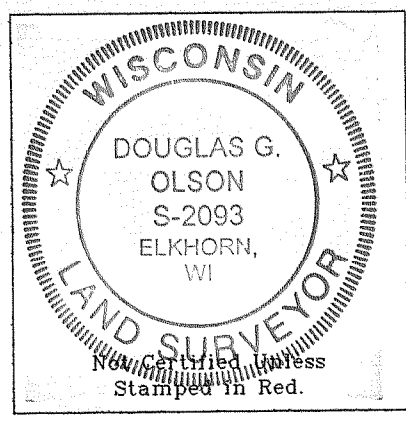

Notes: 1) This survey plat is not
certified unless signed
and sealed in red ink.
2) This survey is subject to Wisconsin lien laws.
This Plat of Survey is the notice of intent
to file lien. Lien waiver required.

Copyright c 2007 by Jensen & Olson Land Surveying, LLC.

All rights reserved. No part of this survey plat may be reproduced
or transmitted in any form by any means - graphic, electronic, or
mechanical, including photocopying, tracing, or information storage
and retrieval systems - without permission in writing from Douglas
G. Olson, Jensen & Olson Land Surveying, LLC.

I, Douglas G. Olson, Wisconsin Registered Land Surveyor,
do hereby certify that this survey was performed by me or under my
direction in full compliance with the owner's/agent's instructions
and Chapter A-E 7 of the Wisconsin Administrative Code "Minimum
Standards for Property Surveys"; and that this map is an accurate
representation thereof to the best of my knowledge and belief.

Douglas G. Olson
Wisconsin Registered Land Surveyor - 2093

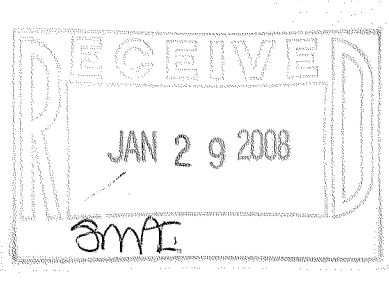

2007.104

Sheet 1 of 1 Sheets
Job Reference Number
2007.104

Legend
Ø Found Iron Pipe
() Recorded Information
X Utility Pole X Septic Vent
Lamp
O Concrete Cover
Asphalt Surface
Concrete Surface Pavers



Jensen & Olson Land Surveying, LLC

45 South Wisconsin Street P.O. Box 322
Elkhorn, Wisconsin. 53121
Telephone (262) 723-3434
Facsimile (262) 723-8044

Scale in Feet
1" = 20'

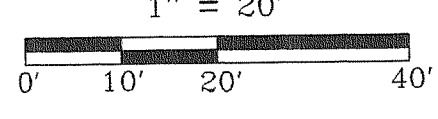

Survey Date: August 24, 2007.
Revisions: No. 1 - Misc.

CBE-21

316-1963